

OWNER/DEVELOPER:
HDC DAVIS RANCH II, LLC
CONTACT PERSON: BRYAN N. SIMS
45 NE LOOP 410 SUITE 225
SAN ANTONIO, TX 78216
TEL: (210) 838-6784

CIVIL ENGINEER:
M.W. CUDE ENGINEERS, L.L.C.
CONTACT PERSON: JEFFREY KINNIE, P.E.
4122 POND HILL ROAD, SUITE 101
SAN ANTONIO, TX 78231
TEL: (210) 681-2951
FAX: (210) 523-7112

- NOTES:**
1. MCCRARY SUBDIVISION UNIT 3 (AP #2679183) IS SUBJECT TO THE CITY OF SAN ANTONIO 2010 TREE ORDINANCE.
 2. NON-EXEMPT TREES ARE CLASSIFIED AS TREES LOCATED OUTSIDE EXEMPT AREAS (STREET R.O.W. & EASEMENTS) & ARE THE TREES USED IN CALCULATING MINIMUM PRESERVATION REQUIREMENTS PER THE 2010 TREE ORDINANCE.
 3. ALL EXISTING TREES DENOTED ON THIS PLAN TO BE PRESERVED AS SHOWN AND PROTECTED AT THE ROOT PROTECTION ZONE (RPZ). THE RPZ SHALL BE DETERMINED BY TREE SIZE (RECOMMENDED 12" RADIUS FROM TRUNK FOR EVERY 1" DIAMETER OF TRUNK AT 4.5' FROM GROUND). NO CUTTING, FILLING, TRENCHING, ROOT DISTURBANCE, OR CONSTRUCTION IMPACTS SHALL OCCUR CLOSER TO THE TRUNK THAN ONE - HALF (½) THE ROOT PROTECTION ZONE.
 4. A (CHAINLINK OR ORANGE MESH FENCE) BARRIER AROUND THE RPZ SHALL BE ERCTED AND MAINTAINED UNTIL CONSTRUCTION IS COMPLETED.
 5. RPZ SHALL BE SUSTAINED IN A NATURAL STATE AND SHALL BE FREE FROM VEHICULAR OR MECHANICAL TRAFFIC; NO FILL, EQUIPMENT, LIQUIDS, OR CONSTRUCTION DEBRIS SHALL BE PLACED INSIDE THE PROTECTIVE BARRIER.
 6. THE RPZ SHALL BE COVERED WITH 6" OF COARSE MULCH TO REDUCE MOISTURE STRESS.
 7. ANY DAMAGE DONE TO EXISTING TREE CROWNS OR ROOT SYSTEMS SHALL BE REPAIRED IMMEDIATELY. ALL WOUNDS TO OAKS WILL BE PAINTED WITH PRUNING PAINT WITHIN 30 MINUTES AFTER DAMAGE. ROOTS EXPOSED DURING CONSTRUCTION OPERATIONS WILL BY CUT CLEANLY.
 8. THE PROPOSED FINISH GRADE AND ELEVATION OF LAND WITHIN THE ROOT PROTECTION ZONE OF ANY TREE TO BE PRESERVED SHALL NOT BE RAISED OR LOWERED MORE THEN 3". WELLING AND RETAINING METHODS ARE ALLOWED OUTSIDE THE RPZ.
 9. THE RPZ SHALL REMAIN PERVIOUS, I.E. GROUND COVER OR TURF AT COMPLETION OF LANDSCAPE DESIGN.
 10. PROTECTED TREES SHALL BE PROTECTED UNTIL SUCH TIME AS THE CONCRETE WORK CAN BE STAKED TO DETERMINE ITS DISTANCE FROM SIGNIFICANT TREES. (IF FOUND THAT THE CONCRETE WORK WILL BE CLOSER THAN 5', THE CONTRACTOR WILL MEET WITH REPRESENTATIVES OF THE ENVIRONMENTAL REVIEW DEPARTMENT TO MINIMIZE IMPACT.)
 11. CONTRACTOR TO UPDATE TREE PRESERVATION PLAN FOR CHANGES DURING CONSTRUCTION AND NOTIFY ENGINEER ACCORDINGLY. THE REVISED TREE PRESERVATION PLAN WILL BE RESUBMITTED AND APPROVED BY THE CITY OF SAN ANTONIO ARBORIST DEPARTMENT UPON FINAL ACCEPTANCE OF ALL SUBDIVISION IMPROVEMENTS.
 12. NO MORE THAN 25% OF TREES PLANTED FOR MITIGATION SHALL BE OF THE SAME SPECIES.
 13. FIVE (5) 3" CALIPER TREES REQUIRED TO BE PLANTED ON EACH RESIDENTIAL LOT.
 14. BUILDING SETBACK DIMENSIONS ARE AS FOLLOWS:
FRONT = 15' REAR = 15' SIDE = 5' SIDE ADJACENT TO STREET = 10'
 15. THERE ARE SIGNIFICANT OR HERITAGE TREES LOCATED WITHIN THE 100 YEAR FLOODPLAIN.
 16. EACH RESIDENTIAL LOT SHALL HAVE FIVE (5) TREES PLANTED TOTALING 15.0" DIAMETER WITH NO SINGLE TREE SMALLER THAN 2.0" DIAMETER. PLANTED TREES SHALL BE A SPECIES WITH A MINIMUM SHADE COVER OF 875 S.F. AS IDENTIFIED IN U.D.C. APPENDIX E: SAN ANTONIO RECOMMENDED PLANT LIST - ALL SUITED TO XERISCAPE PLANTING METHODS.
 17. DEVELOPER TO PROVIDE IRRIGATION ON PLANTED STREET AND OPEN SPACE LOT TREES FOR A MINIMUM OF 3 YEARS.

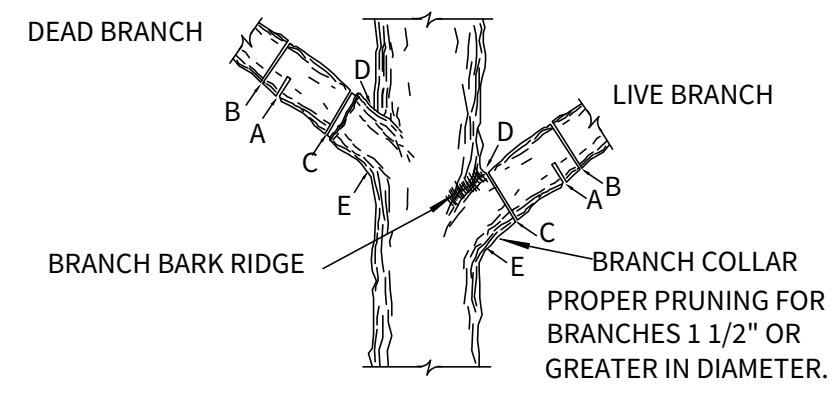
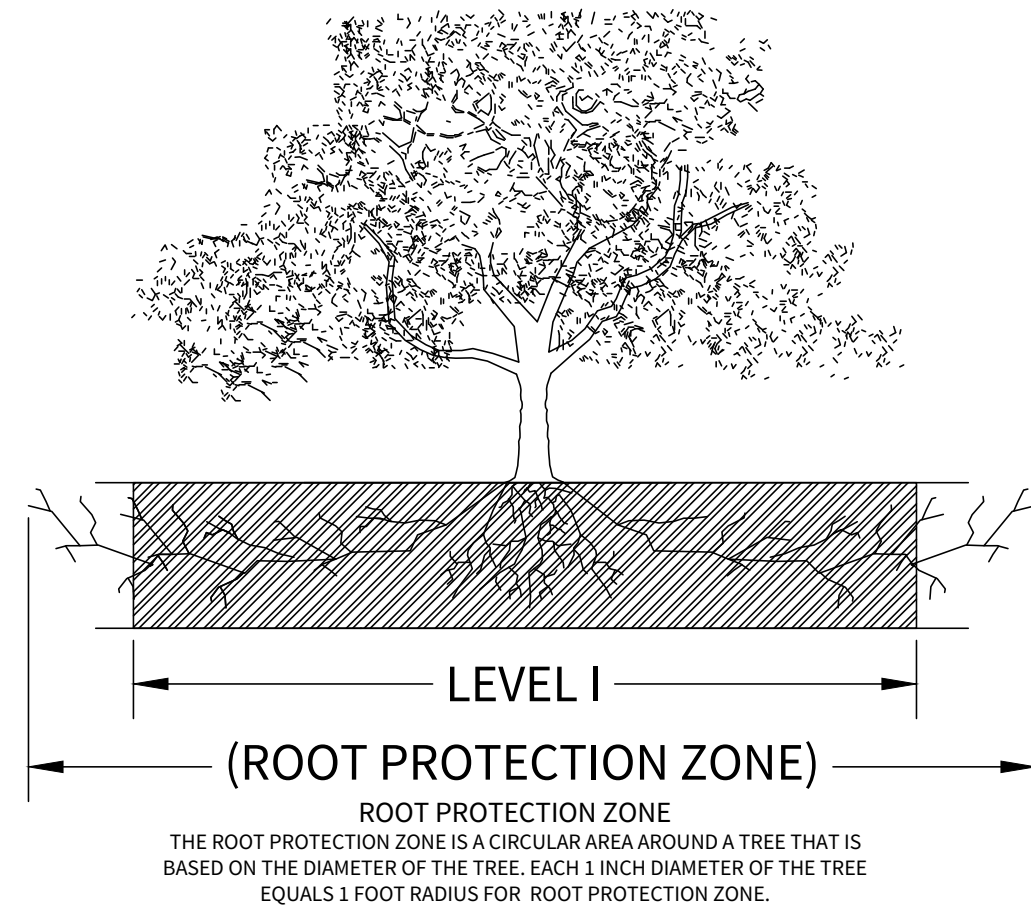

NOTE: DO NOT CUT FROM D to E.

- A. FIRST CUT - TO PREVENT THE BARK FROM BEING PEELED WHEN THE BRANCH FALLS.
- B. SECOND CUT - TO REDUCE THE WEIGHT OF BRANCH.
- C. FINAL CUT - ALLOW FOR HEALING COLLAR BUT NO STUBS
- D. BRANCH RIDGES - INDENT PROPERLY BRANCH RIDGES WHICH ARE SITE FOR DECA.

FOR OAKS ONLY: PAINT ALL WOUNDS OR CUTS WITH PRUNING PAINT WITHIN 20 MIN TO PREVENT THE SPREAD OF OAK WILT.

LEGEND

- SIGNIFICANT TREE TO BE PRESERVED
- SIGNIFICANT TREE TO BE REMOVED
- HERITAGE TREE TO BE PRESERVED
- HERITAGE TREE TO BE REMOVED
- EXEMPT TREE PRESERVED
- EXEMPT TREE REMOVED
- TREES REMOVED IN TREE PLAN AP #2529534 (NOT INCLUDED IN THIS TREE PLAN)

SCALE: 1"=50'

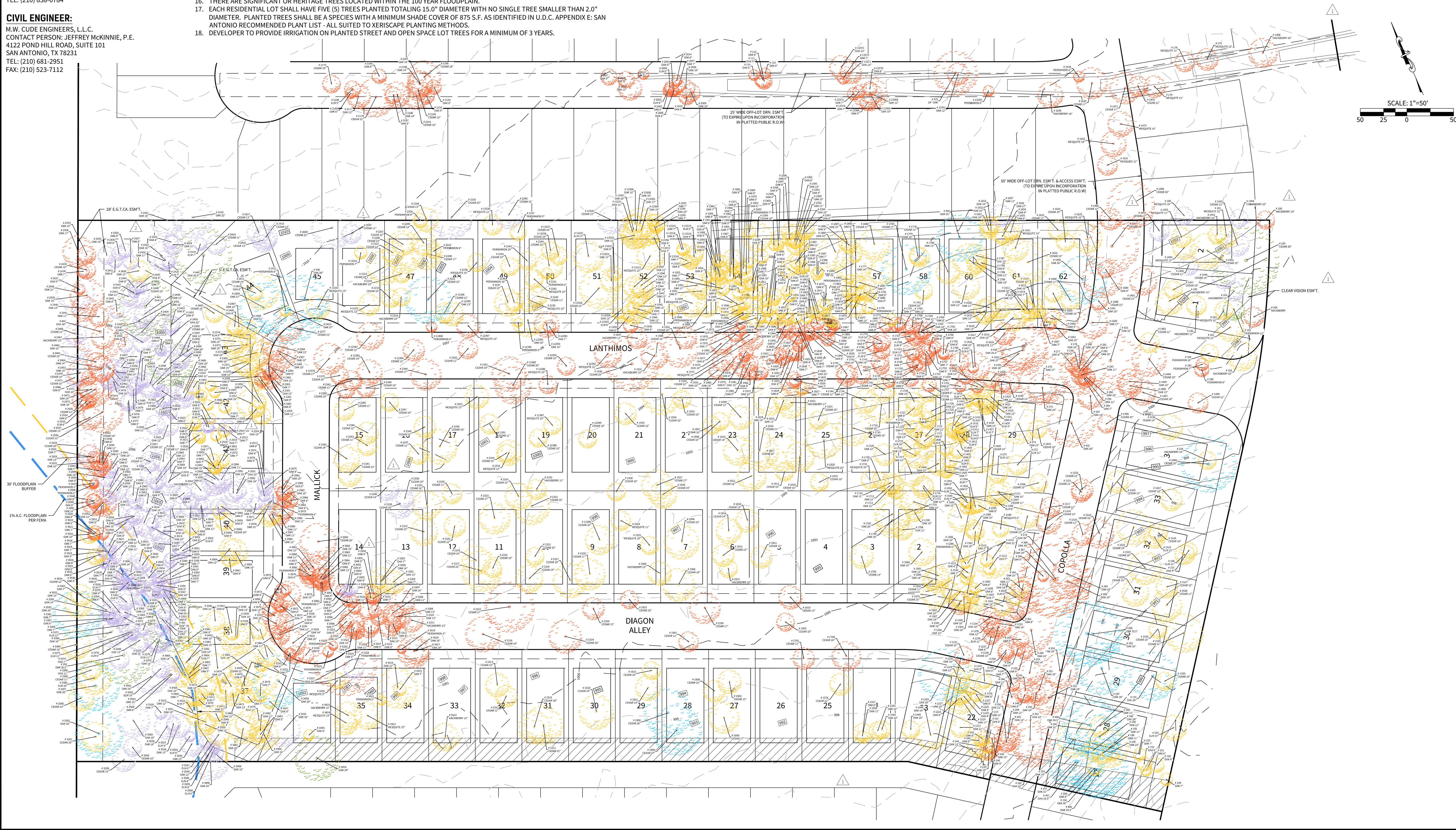

CUDEENGINEERS.COM

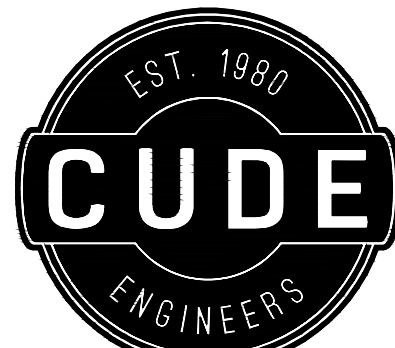

4122 Pond Hill Road, Suite 101
San Antonio, Texas 78231
P:(210) 681.2951 F:(210) 523.7112

MCCRARY TRACT
UNIT 3

TREE PRESERVATION PLAN

DATE

10/13/2021

PROJECT NO.
02142.631

DRAWN BY
JRT/MAT/NNR

CHECKED BY
JAM/SWM

REVISIONS

- 01/28/2021 - TREE REVISIONS
- 07/20/2021 - ADD E.G.T. CA. EASEMENT BETWEEN LOTS 43 & 44
-
-
-
-
-
-
-

CUDE ENGINEERS

TBPE No. 455

TBPLS No. 10048500

LAND-PLAT

20-11800554

SAWS JOB NO.

TPP-1

1 OF 11

REPRODUCTION OF THE ORIGINAL SIGNED AND SEALED PLAN AND/OR ELECTRONIC MEDIA MAY HAVE BEEN INADVERTENTLY ALTERED. CONTRACTOR IS RESPONSIBLE FOR VERIFYING THE SCALE OF THE DOCUMENT AND CONTACTING CUDE ENGINEERS TO VERIFY DISCREPANCIES PRIOR TO CONSTRUCTION.

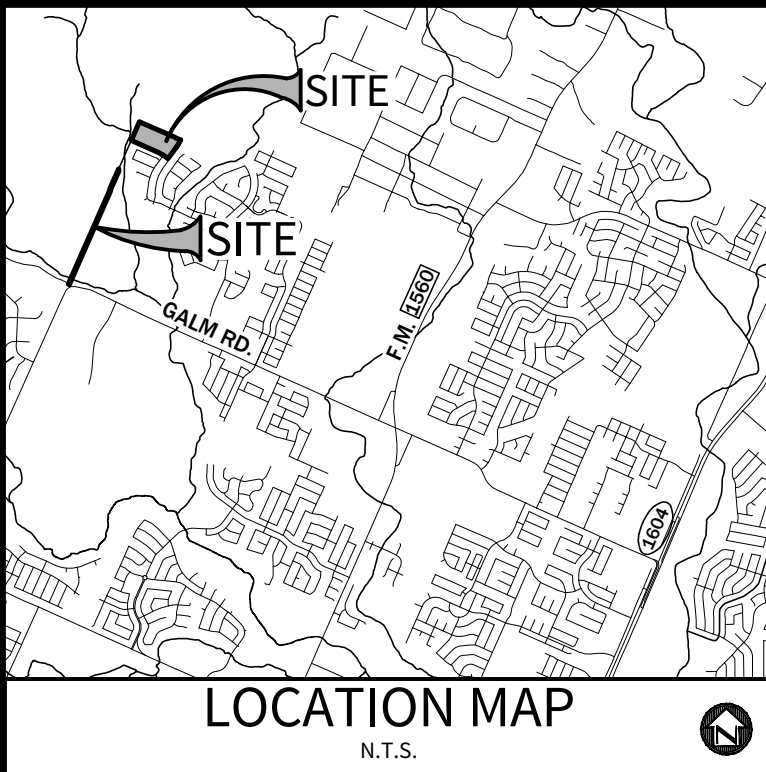

OWNER/DEVELOPER:
HDC DAVIS RANCH II, LLC
CONTACT PERSON: BRYAN N. SIMS
45 NE LOOP 410 SUITE 225
SAN ANTONIO, TX 78231
TEL: (210) 838-6784

CIVIL ENGINEER:
M.W. CUDE ENGINEERS, L.L.C.
CONTACT PERSON: JEFFREY MCKINNIE, P.E.
4122 POND HILL ROAD, SUITE 101
SAN ANTONIO, TX 78231
TEL: (210) 681-2951
FAX: (210) 523-7112

- NOTES:**
1. MCCRARY SUBDIVISION UNIT 3 (AP #2679183) IS SUBJECT TO THE CITY OF SAN ANTONIO 2010 TREE ORDINANCE.
 2. NON-EXEMPT TREES ARE CLASSIFIED AS TREES LOCATED OUTSIDE EXEMPT AREAS (STREET R.O.W. & EASEMENTS) & ARE THE TREES USED IN CALCULATING MINIMUM PRESERVATION REQUIREMENTS PER THE 2010 TREE ORDINANCE.
 3. ALL EXISTING TREES DENOTED ON THIS PLAN TO BE PRESERVED AS SHOWN AND PROTECTED AT THE ROOT PROTECTION ZONE (RPZ). THE RPZ SHALL BE DETERMINED BY TREE SIZE (RECOMMENDED 12" RADIUS FROM TRUNK FOR EVERY 1" DIAMETER OF TRUNK AT 4.5' FROM GROUND). NO CUTTING, FILLING, TRENCHING, ROOT DISTURBANCE, OR CONSTRUCTION IMPACTS SHALL OCCUR CLOSER TO THE TRUNK THAN ONE -HALF (½) THE ROOT PROTECTION ZONE.
 4. A (CHAINLINK OR ORANGE MESH FENCE) BARRIER AROUND THE RPZ SHALL BE ERRECTED AND MAINTAINED UNTIL CONSTRUCTION IS COMPLETED.
 5. RPZ SHALL BE SUSTAINED IN A NATURAL STATE AND SHALL BE FREE FROM VEHICULAR OR MECHANICAL TRAFFIC; NO FILL, EQUIPMENT, LIQUIDS, OR CONSTRUCTION DEBRIS SHALL BE PLACED INSIDE THE PROTECTIVE BARRIER.
 6. THE RPZ SHALL BE COVERED WITH 6" OF COARSE MULCH TO REDUCE MOISTURE STRESS.
 7. ANY DAMAGE DONE TO EXISTING TREE CROWNS OR ROOT SYSTEMS SHALL BE REPAIRED IMMEDIATELY. ALL WOUNDS TO OAKS WILL BE PAINTED WITH PRUNING PAINT WITHIN 30 MINUTES AFTER DAMAGE. ROOTS EXPOSED DURING CONSTRUCTION OPERATIONS WILL BY CUT CLEANLY.
 8. THE PROPOSED FINISH GRADE AND ELEVATION OF LAND WITHIN THE ROOT PROTECTION ZONE OF ANY TREE TO BE PRESERVED SHALL NOT BE RAISED OR LOWERED MORE THEN 3". WELLING AND RETAINING METHODS ARE ALLOWED OUTSIDE THE RPZ.
 9. THE RPZ SHALL REMAIN PERVIOUS, I.E. GROUND COVER OR TURF AT COMPLETION OF LANDSCAPE DESIGN.
 10. PROTECTED TREES SHALL BE PROTECTED UNTIL SUCH TIME AS THE CONCRETE WORK CAN BE STAKED TO DETERMINE ITS DISTANCE FROM SIGNIFICANT TREES. (IF FOUND THAT THE CONCRETE WORK WILL BE CLOSER THAN 5', THE CONTRACTOR WILL MEET WITH REPRESENTATIVES OF THE ENVIRONMENTAL REVIEW DEPARTMENT TO MINIMIZE IMPACT.)
 11. CONTRACTOR TO UPDATE TREE PRESERVATION PLAN FOR CHANGES DURING CONSTRUCTION AND NOTIFY ENGINEER ACCORDINGLY. THE REVISED TREE PRESERVATION PLAN WILL BE RESUBMITTED AND APPROVED BY THE CITY OF SAN ANTONIO ARBORIST DEPARTMENT UPON FINAL ACCEPTANCE OF ALL SUBDIVISION IMPROVEMENTS.
 12. NO MORE THAN 25% OF TREES PLANTED FOR MITIGATION SHALL BE OF THE SAME SPECIES.
 13. FIVE (5) 3" CALIPER TREES REQUIRED TO BE PLANTED ON EACH RESIDENTIAL LOT.
 14. BUILDING SETBACK DIMENSIONS ARE AS FOLLOWS:
FRONT = 15' REAR = 15' SIDE = 5' SIDE ADJACENT TO STREET = 10'
 15. THERE ARE SIGNIFICANT OR HERITAGE TREES LOCATED WITHIN THE 100 YEAR FLOODPLAIN.
 16. EACH RESIDENTIAL LOT SHALL HAVE FIVE (5) TREES PLANTED TOTALING 15.0" DIAMETER WITH NO SINGLE TREE SMALLER THAN 2.0" DIAMETER. PLANTED TREES SHALL BE A SPECIES WITH A MINIMUM SHADE COVER OF 875 S.F. AS IDENTIFIED IN U.D.C. APPENDIX E: SAN ANTONIO RECOMMENDED PLANT LIST - ALL SUITED TO XERISCAPE PLANTING METHODS.
 17. DEVELOPER TO PROVIDE IRRIGATION ON PLANTED STREET AND OPEN SPACE LOT TREES FOR A MINIMUM OF 3 YEARS.

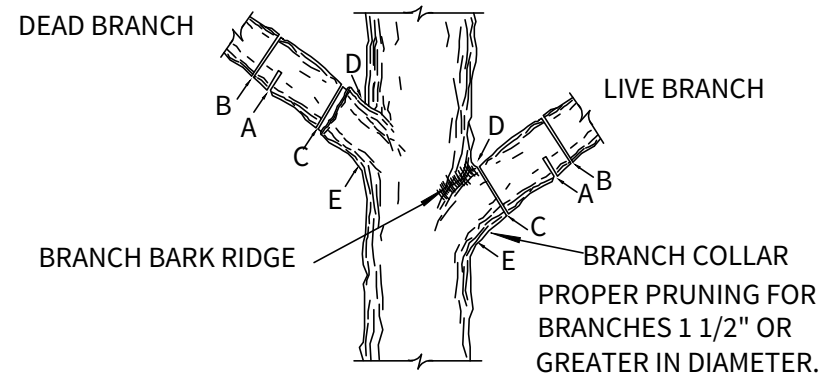
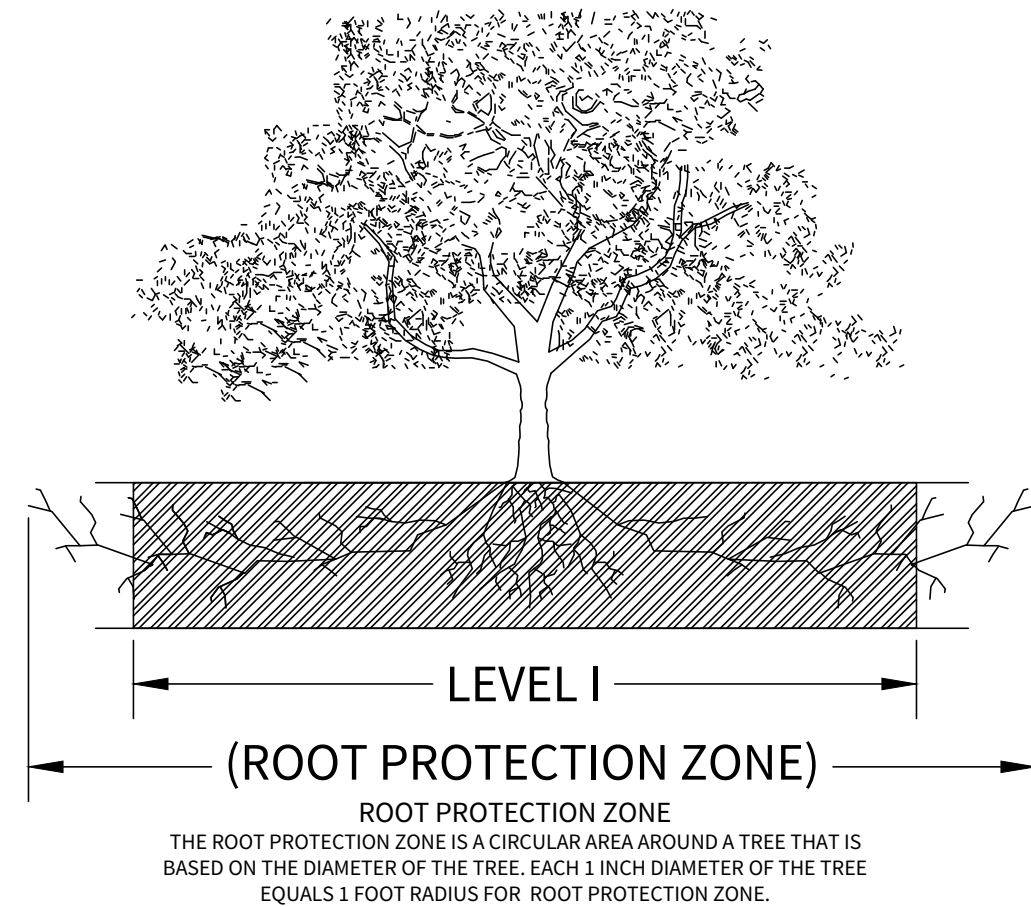

NOTE: DO NOT CUT FROM D TO E.

- A. FIRST CUT - TO PREVENT THE BARK FROM BEING PEELED WHEN THE BRANCH FALLS.
- B. SECOND CUT - TO REDUCE THE WEIGHT OF BRANCH.
- C. FINAL CUT - ALLOW FOR HEALING COLLAR BUT NO STUBS
- D. BRANCH RIDGES - INDENT PROPERLY BRANCH RIDGES WHICH ARE SITE FOR DECA.

FOR OAKS ONLY: PAINT ALL WOUNDS OR CUTS WITH PRUNING PAINT WITHIN 20 MIN TO PREVENT THE SPREAD OF OAK WILT.

LEGEND

- MITIGATION PLANTED TREE - NO ENERGY CREDIT
- MITIGATION PLANTED TREE - ENERGY CREDIT
- REQUIRED PLANTED TREE - NO ENERGY CREDIT
- REQUITED PLANTED TREE - ENERGY CREDIT

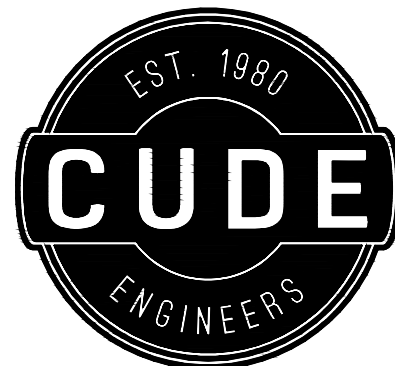
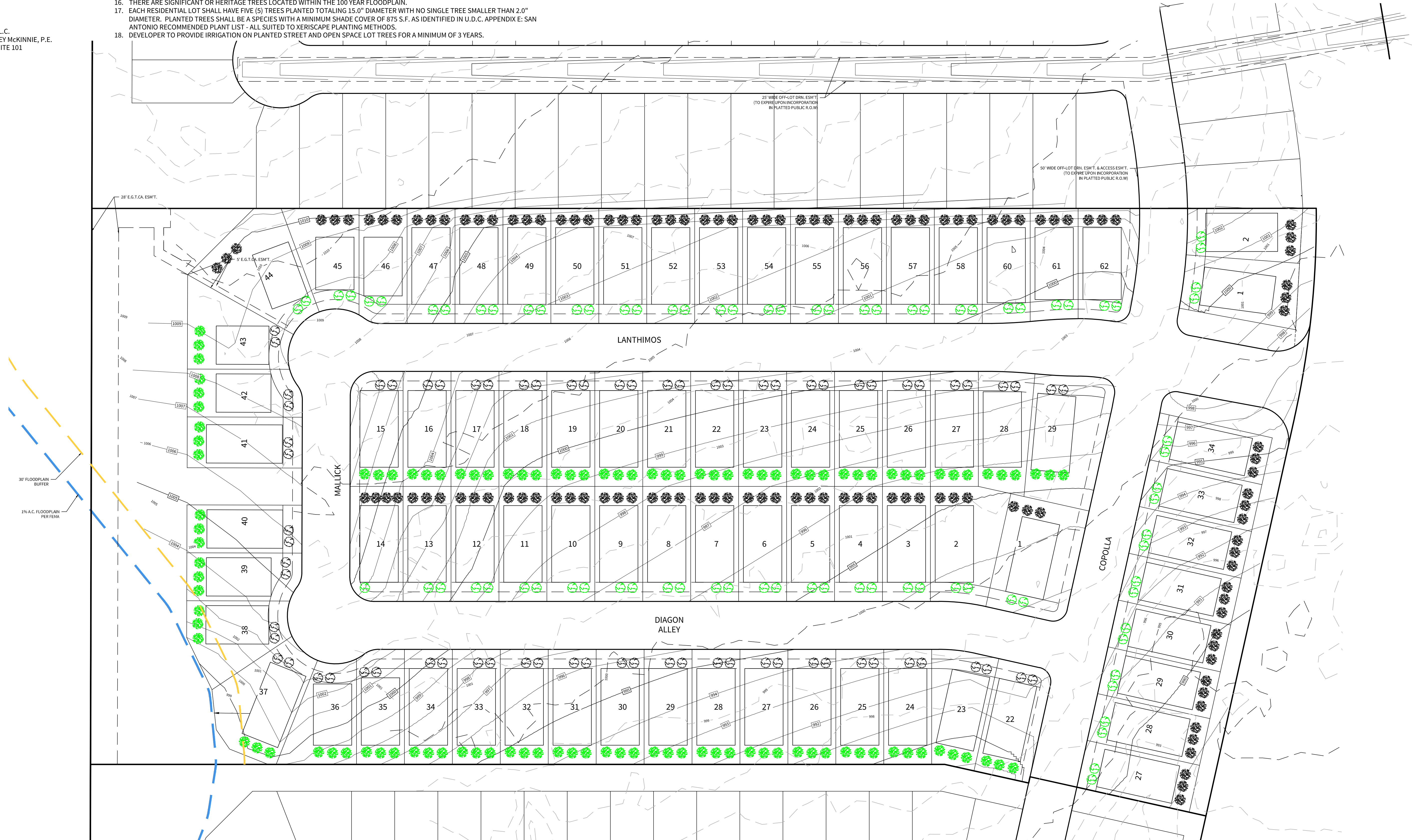
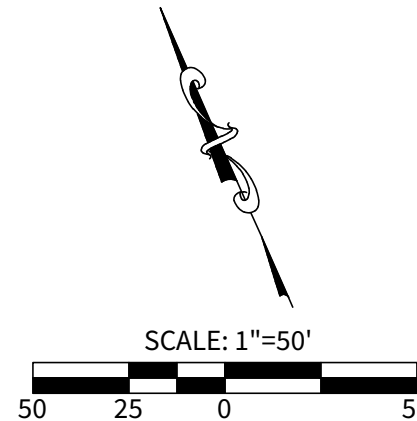

4122 Pond Hill Road, Suite 101
San Antonio, Texas 78231
P:(210) 681.2951 F:(210) 523.7112

MCCRARY TRACT UNIT 3

TREE PRESERVATION PLAN

DATE

10/13/2021

PROJECT NO.

02142.631

DRAWN BY

JRT/MAT/NNR

CHECKED BY

JAM/SWM

REVISIONS

- 01/28/2021 - TREE REVISIONS
- 07/20/2021 - ADD E.G.T.C.A. EASEMENT BETWEEN LOTS 43 & 44
-
-
-
-
-
-
-

CUDE ENGINEERS

TBPE No. 455

TBPLS No. 10048500

LAND-PLAT

20-11800554

SAWS JOB NO.

TPP-2

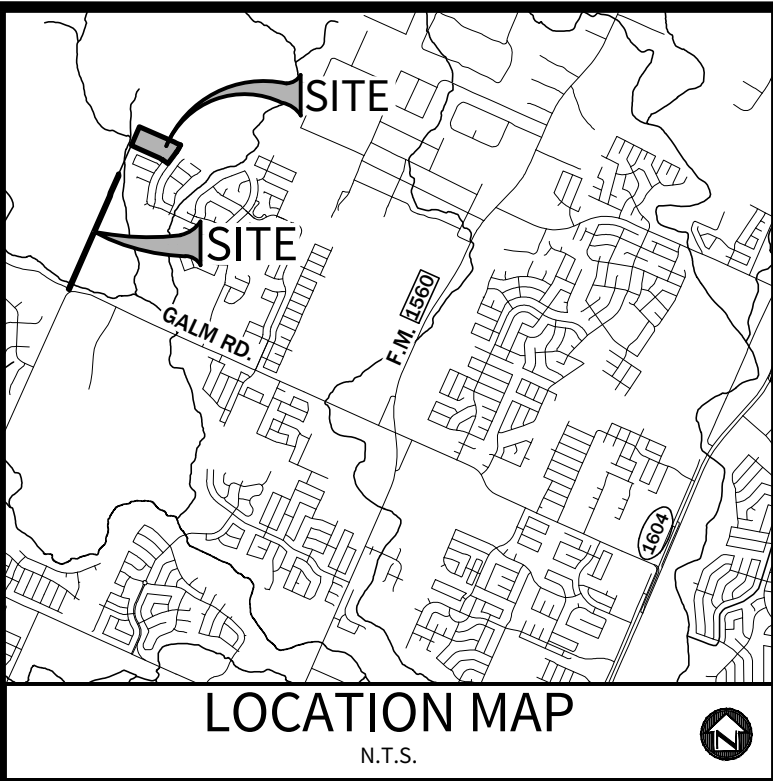

OWNER/DEVELOPER:
HDC DAVIS RANCH II, LLC
CONTACT PERSON: BRYAN N. SIMS
45 NE LOOP 410 SUITE 225
SAN ANTONIO, TX 78216
TEL: (210) 838-6784

CIVIL ENGINEER:
M.W. CUDE ENGINEERS, L.L.C.
CONTACT PERSON: JEFFREY MCKINNIE, P.E.
4122 POND HILL ROAD, SUITE 101
SAN ANTONIO, TX 78231
TEL: (210) 681-2951
FAX: (210) 523-7112

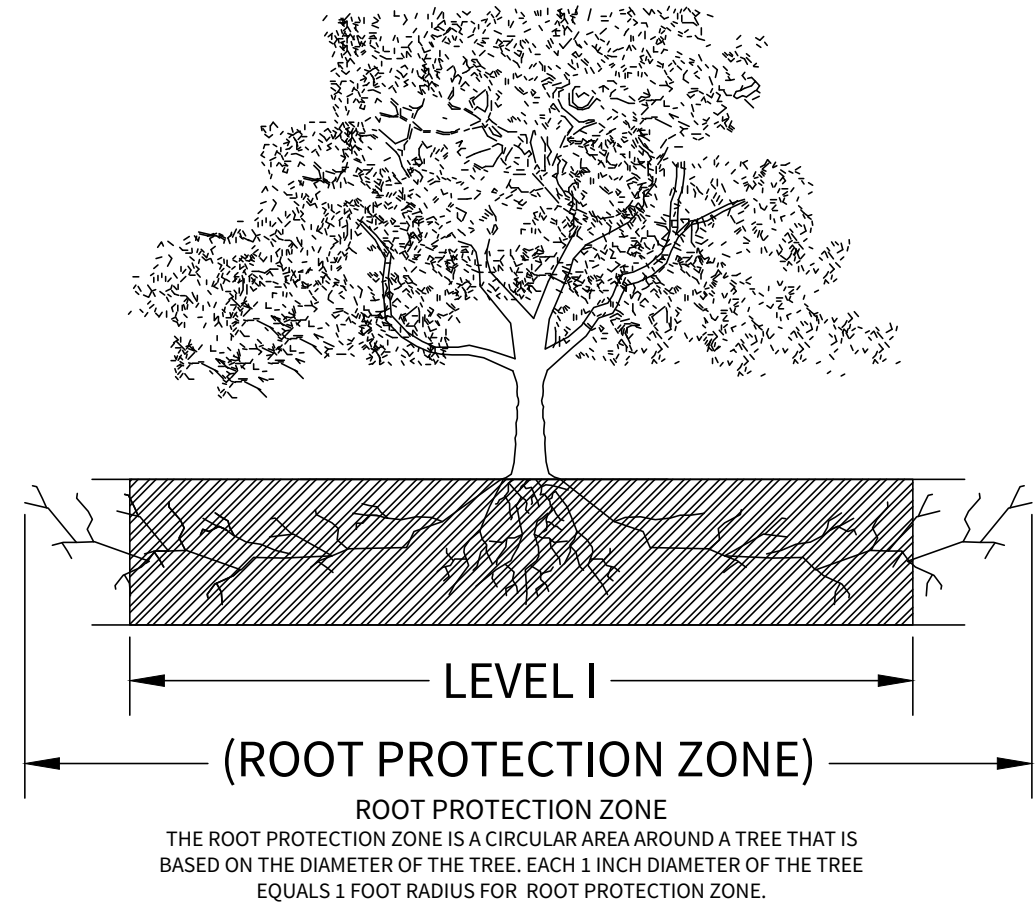
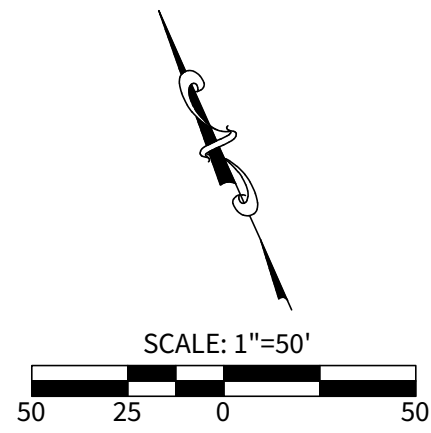

- LEGEND**
- SIGNIFICANT TREE TO BE REMOVED
 - EXEMPT TREE REMOVED
 - HERITAGE TREE REMOVED
 - TREE PLAN LIMITS
 - FLOODPLAIN LIMITS
 - ENVIRONMENTALLY SENSITIVE AREA LIMITS

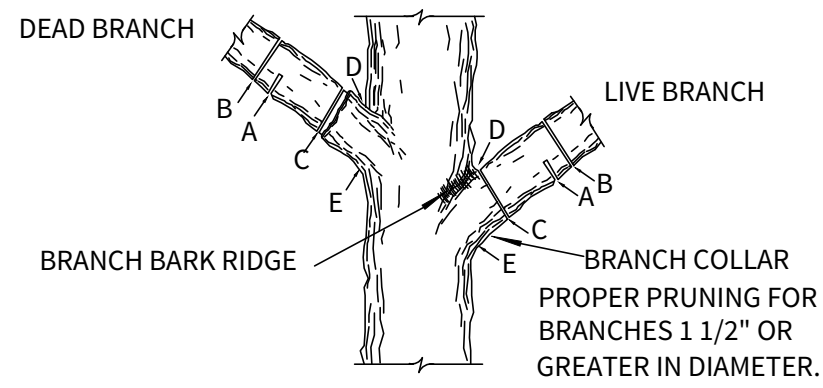

NOTE: DO NOT CUT FROM D TO E.

- FIRST CUT - TO PREVENT THE BARK FROM BEING PEELED WHEN THE BRANCH FALLS.
- SECOND CUT - TO REDUCE THE WEIGHT OF BRANCH.
- FINAL CUT - ALLOW FOR HEALING COLLAR BUT NO STUBS
- BRANCH RIDGES - INDENT PROPERLY BRANCH RIDGES WHICH ARE SITE FOR DECAY.

FOR OAKS ONLY: PAINT ALL WOUNDS OR CUTS WITH PRUNING PAINT WITHIN 20 MIN TO PREVENT THE SPREAD OF OAK WILT.

- NOTES:**
- MCCRARY TRACT SUBDIVISION IS SUBJECT TO THE CITY OF SAN ANTONIO 2010 TREE ORDINANCE
 - NON-EXEMPT TREES ARE CLASSIFIED AS TREES LOCATED OUTSIDE EXEMPT AREAS (STREET R.O.W. & EASEMENTS) & ARE THE TREES USED IN CALCULATING MINIMUM PRESERVATION REQUIREMENTS PER THE 2010 TREE ORDINANCE.
 - ANY SUBSEQUENT NOTES DEALING WITH ROOT PROTECTION DO NOT APPLY TO RESIDENTIAL DEVELOPMENTS.
 - ALL EXISTING TREES DENOTED ON THIS PLAN TO BE PRESERVED AS SHOWN AND PROTECTED AT THE ROOT PROTECTION ZONE (RPZ). THE RPZ SHALL BE DETERMINED BY TREE SIZE (RECOMMENDED 12" RADIUS FROM TRUNK FOR EVERY 1" DIAMETER OF TRUNK AT 4.5' FROM GROUND) WITH A MINIMUM 5' DIAMETER FROM THE TRUNK.
 - A (CHAINLINK OR ORANGE MESH FENCE) BARRIER AROUND THE RPZ SHALL BE ERECTED AND MAINTAINED UNTIL CONSTRUCTION IS COMPLETED.
 - RPZ SHALL BE SUSTAINED IN A NATURAL STATE AND SHALL BE FREE FROM VEHICULAR OR MECHANICAL TRAFFIC; NO FILL, EQUIPMENT, LIQUIDS, OR CONSTRUCTION DEBRIS SHALL BE PLACED INSIDE THE PROTECTIVE BARRIER.
 - THE RPZ SHALL BE COVERED WITH 6" OF COARSE MULCH TO REDUCE MOISTURE STRESS.
 - ANY DAMAGE DONE TO EXISTING TREE CROWNS OR ROOT SYSTEMS SHALL BE REPAIRED IMMEDIATELY. ALL WOUNDS TO OAKS WILL BE PAINTED WITH PRUNING PAINT WITHIN 30 MINUTES AFTER DAMAGE. ROOTS EXPOSED DURING CONSTRUCTION OPERATIONS WILL BE CUT CLEANLY.
 - THE PROPOSED FINISH GRADE AND ELEVATION OF LAND WITHIN THE ROOT PROTECTION ZONE OF ANY TREE TO BE PRESERVED SHALL NOT BE RAISED OR LOWERED MORE THAN 3". WELLING AND RETAINING METHODS ARE ALLOWED OUTSIDE THE RPZ.
 - THE RPZ SHALL REMAIN PERVIOUS, I.E. GROUND COVER OR TURF AT COMPLETION OF LANDSCAPE DESIGN.
 - PROTECTED TREES SHALL BE PROTECTED UNTIL SUCH TIME AS THE CONCRETE WORK CAN BE STAKED TO DETERMINE ITS DISTANCE FROM SIGNIFICANT TREES. (IF FOUND THAT THE CONCRETE WORK WILL BE CLOSER THAN 5', THE CONTRACTOR WILL MEET WITH REPRESENTATIVES OF THE ENVIRONMENTAL REVIEW DEPARTMENT TO MINIMIZE IMPACT.)
 - CONTRACTOR TO UPDATE TREE PRESERVATION PLAN FOR CHANGES DURING CONSTRUCTION AND NOTIFY ENGINEER ACCORDINGLY. THE REVISED TREE PRESERVATION PLAN WILL BE RESUBMITTED AND APPROVED BY THE CITY OF SAN ANTONIO ARBORIST DEPARTMENT UPON FINAL ACCEPTANCE OF ALL SUBDIVISION IMPROVEMENTS.

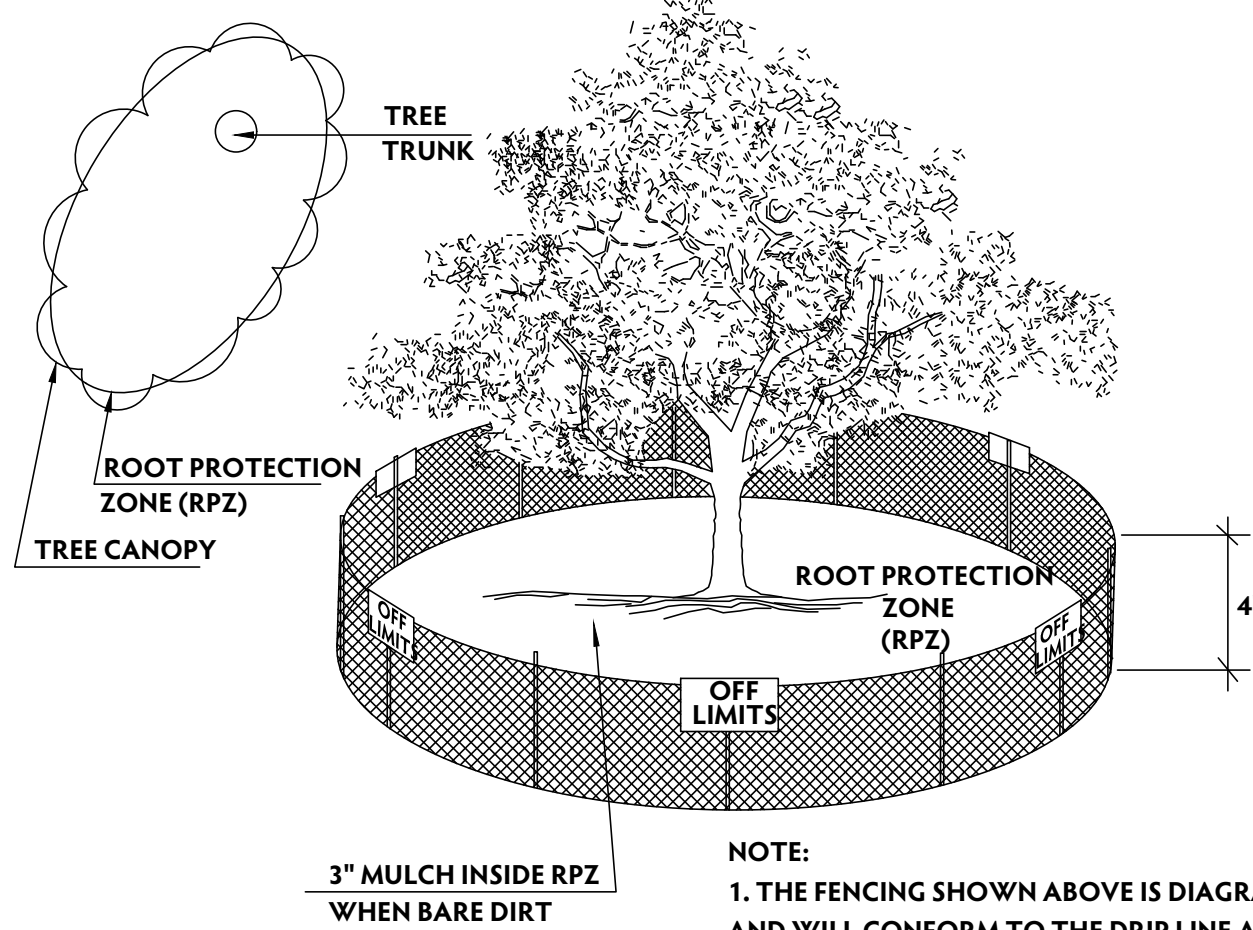

- NOTE:**
- THE FENCING SHOWN ABOVE IS DIAGRAMATIC ONLY AND WILL CONFORM TO THE DRIP LINE AND LIMITED TO PROJECT BOUNDARY.
 - FOR ACCEPTABLE FENCING MATERIALS SEE SPECIFICATIONS.

1.1.2 LEVEL I & FENCE PROTECTION

N.T.S.

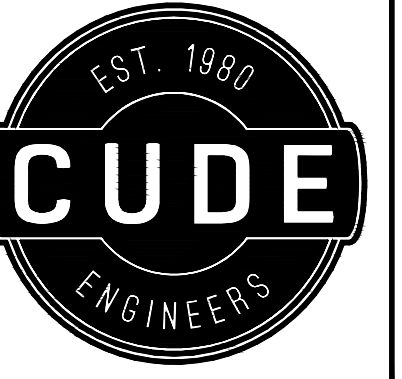
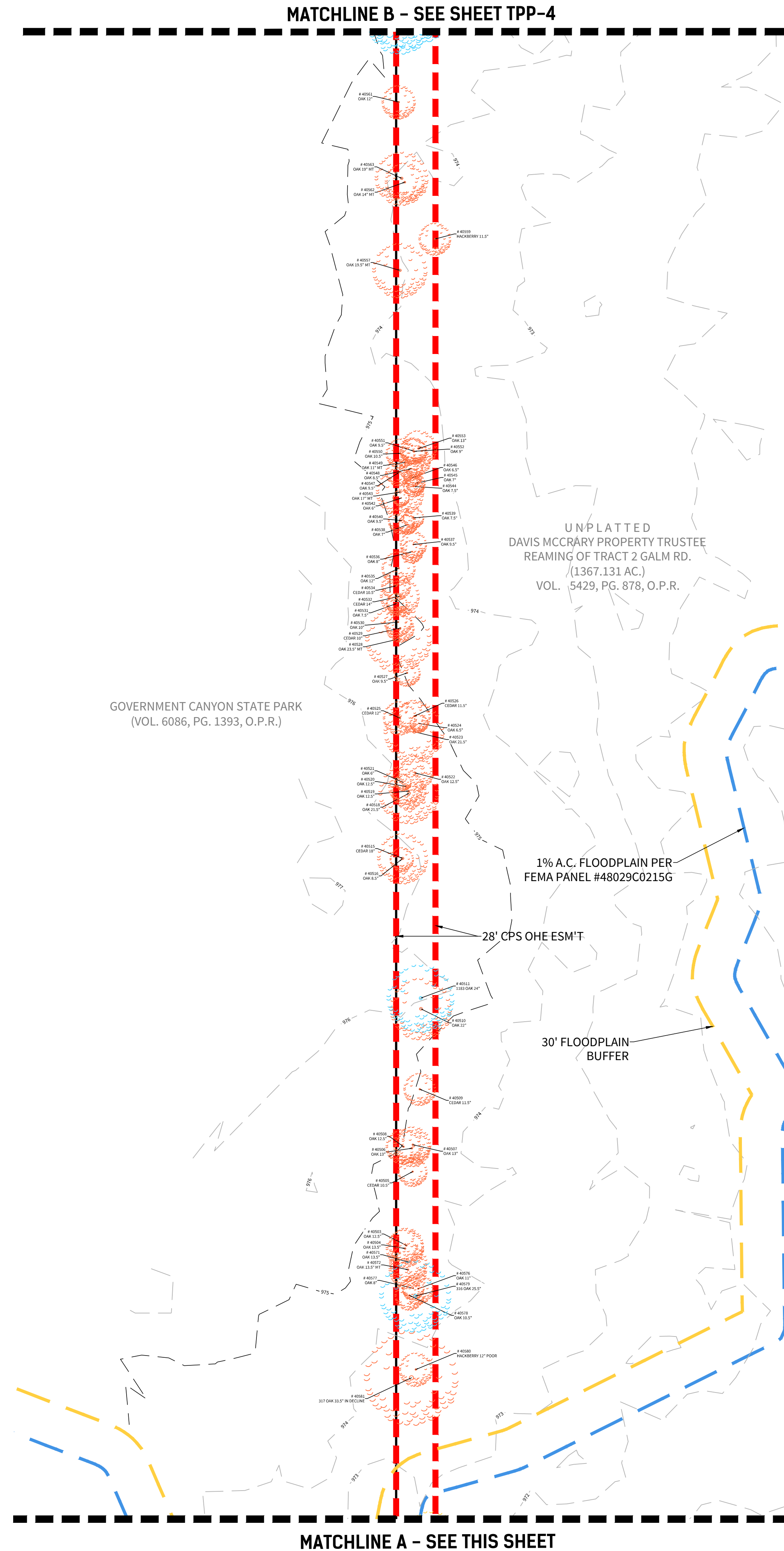
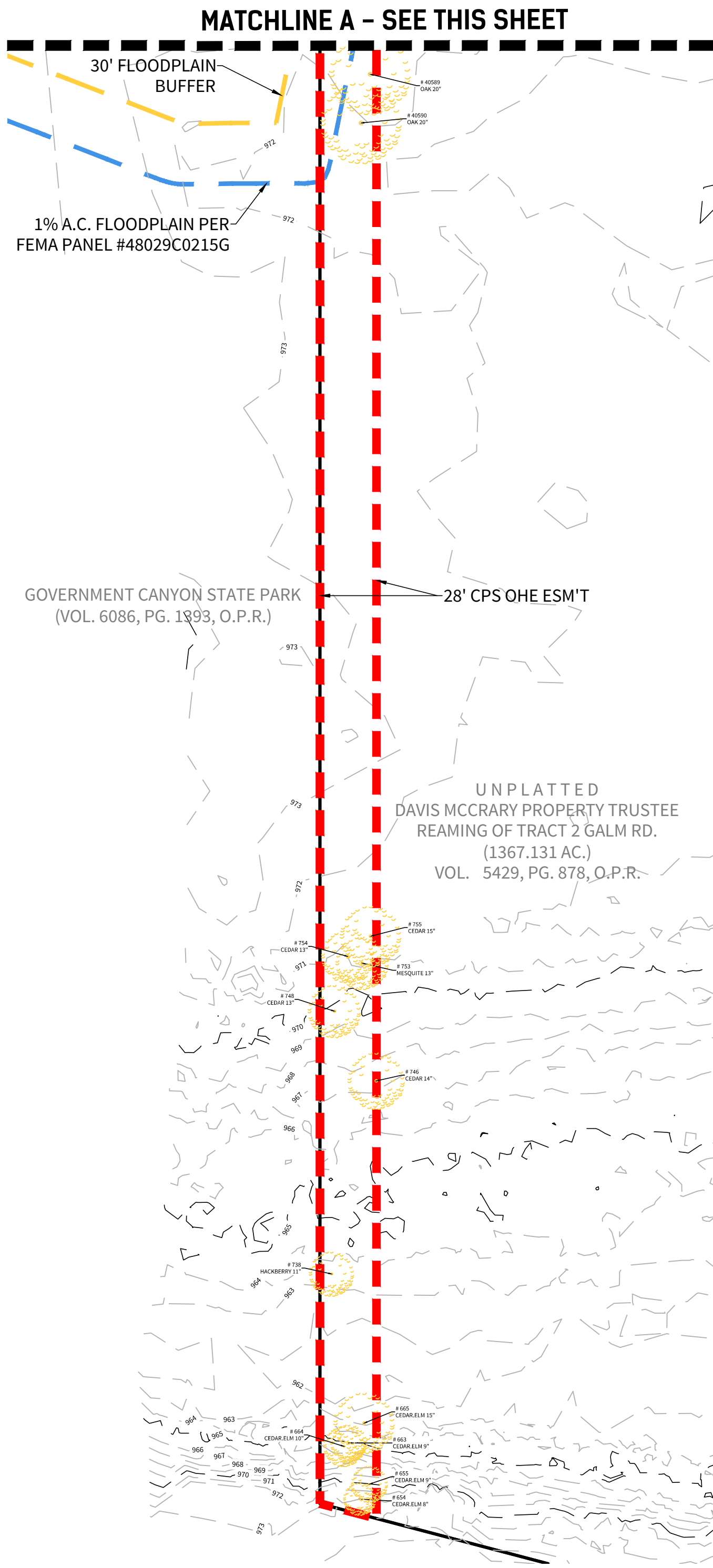

4122 Pond Hill Road, Suite 101
San Antonio, Texas 78231
P:(210) 681.2951 F:(210) 523.7112

MCCRARY TRACT UNIT 3 TREE PRESERVATION PLAN

DATE
10/13/2021

PROJECT NO.
02142.631

DRAWN BY
JRT/MAT/NNR

CHECKED BY
JAM/SWM

REVISIONS
1. 10/06/2021 - COMBINED CPS OHE
2. TREE PLAN
3.
4.
5.
6.
7.
8.
9.

CUDE ENGINEERS
TBPE No. 455
TBPLS No. 10048500

LAND-PLAT
20-11800554
SAWS JOB NO.

TPP-3

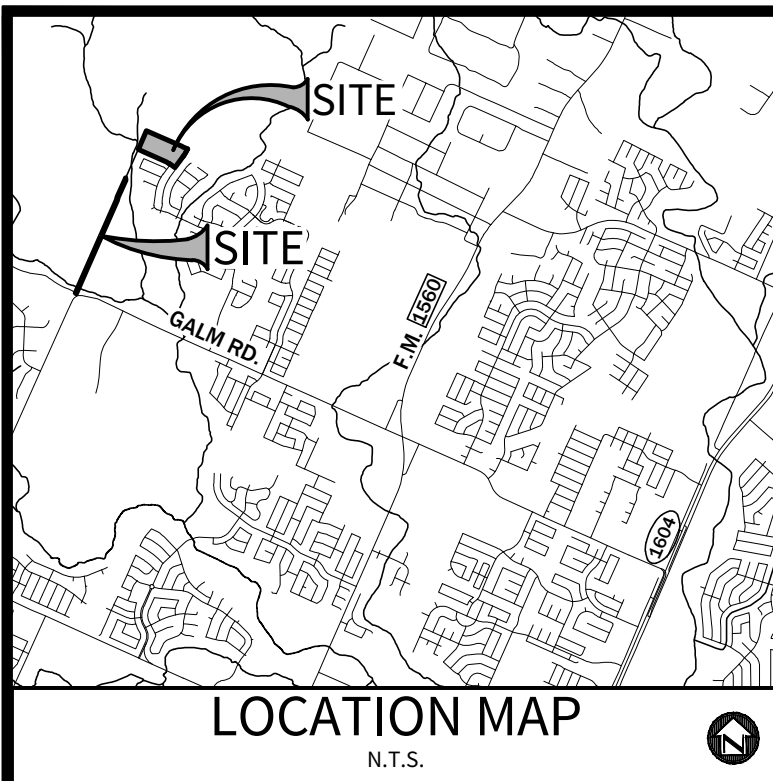

OWNER/DEVELOPER:
HDC DAVIS RANCH II, LLC
CONTACT PERSON: BRYAN N. SIMS
45 NE LOOP 410 SUITE 225
SAN ANTONIO, TX 78216
TEL: (210) 838-6784

CIVIL ENGINEER:
M.W. CUDE ENGINEERS, L.L.C.
CONTACT PERSON: JEFFREY MCKINNIE, P.E.
4122 POND HILL ROAD, SUITE 101
SAN ANTONIO, TX 78231
TEL: (210) 681-2951
FAX: (210) 523-7112

LEGEND

- SIGNIFICANT TREE TO BE REMOVED
- EXEMPT TREE REMOVED
- HERITAGE TREE REMOVED
- TREE PLAN LIMITS
- FLOODPLAIN LIMITS
- ENVIRONMENTALLY SENSITIVE AREA LIMITS

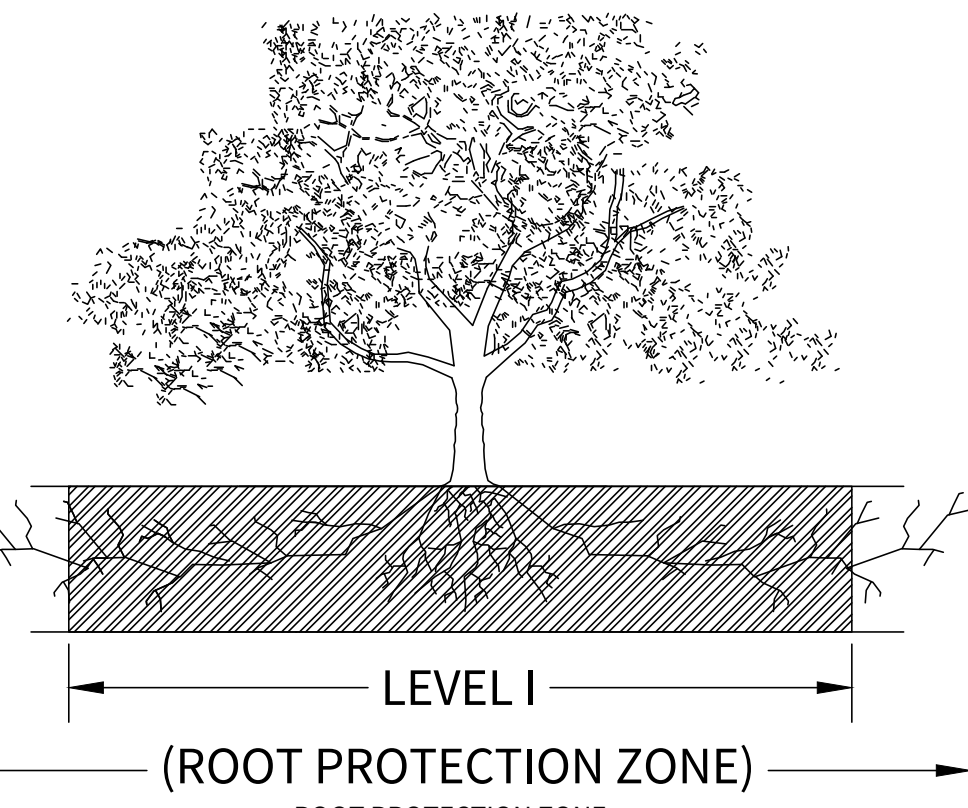

ROOT PROTECTION ZONE
THE ROOT PROTECTION ZONE IS A CIRCULAR AREA AROUND A TREE THAT IS BASED ON THE DIAMETER OF THE TREE. EACH 1 INCH DIAMETER OF THE TREE EQUALS 1 FOOT RADIUS FOR ROOT PROTECTION ZONE.

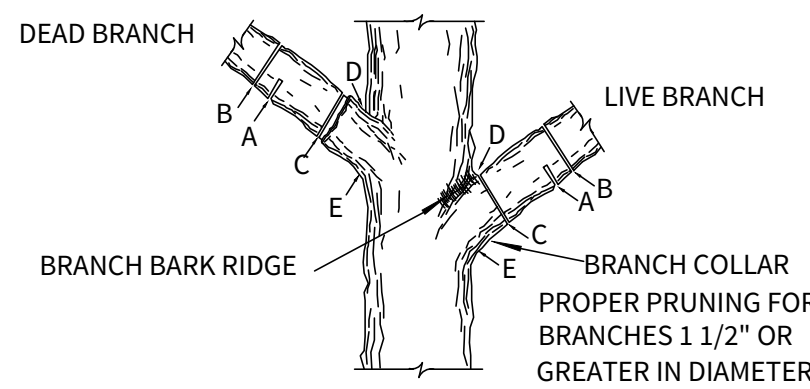

NOTE: DO NOT CUT FROM D TO E.

- A. FIRST CUT - TO PREVENT THE BARK FROM BEING PEELED WHEN THE BRANCH FALLS.
- B. SECOND CUT - TO REDUCE THE WEIGHT OF BRANCH.
- C. FINAL CUT - ALLOW FOR HEALING COLLAR BUT NO STUBS
- D. BRANCH RIDGES - INDENT PROPERLY BRANCH RIDGES WHICH ARE SITE FOR DECAY.

FOR OAKS ONLY: PAINT ALL WOUNDS OR CUTS WITH PRUNING PAINT WITHIN 20 MIN TO PREVENT THE SPREAD OF OAK WILT.

NOTES:

- MCCRARY TRACT SUBDIVISION IS SUBJECT TO THE CITY OF SAN ANTONIO 2010 TREE ORDINANCE
- NON-EXEMPT TREES ARE CLASSIFIED AS TREES LOCATED OUTSIDE EXEMPT AREAS (STREET R.O.W. & EASEMENTS) & ARE THE TREES USED IN CALCULATING MINIMUM PRESERVATION REQUIREMENTS PER THE 2010 TREE ORDINANCE.
- ANY SUBSEQUENT NOTES DEALING WITH ROOT PROTECTION DO NOT APPLY TO RESIDENTIAL DEVELOPMENTS.
- ALL EXISTING TREES DENOTED ON THIS PLAN TO BE PRESERVED AS SHOWN AND PROTECTED AT THE ROOT PROTECTION ZONE (RPZ). THE RPZ SHALL BE DETERMINED BY TREE SIZE (RECOMMENDED 12\"/>
- A (CHAINLINK OR ORANGE MESH FENCE) BARRIER AROUND THE RPZ SHALL BE ERCTED AND MAINTAINED UNTIL CONSTRUCTION IS COMPLETED.
- RPZ SHALL BE SUSTAINED IN A NATURAL STATE AND SHALL BE FREE FROM VEHICULAR OR MECHANICAL TRAFFIC; NO FILL, EQUIPMENT, LIQUIDS, OR CONSTRUCTION DEBRIS SHALL BE PLACED INSIDE THE PROTECTIVE BARRIER.
- THE RPZ SHALL BE COVERED WITH 6\"/>
- ANY DAMAGE DONE TO EXISTING TREE CROWNS OR ROOT SYSTEMS SHALL BE REPAIRED IMMEDIATELY. ALL WOUNDS TO OAKS WILL BE PAINTED WITH PRUNING PAINT WITHIN 30 MINUTES AFTER DAMAGE. ROOTS EXPOSED DURING CONSTRUCTION OPERATIONS WILL BE CUT CLEANLY.
- THE PROPOSED FINISH GRADE AND ELEVATION OF LAND WITHIN THE ROOT PROTECTION ZONE OF ANY TREE TO BE PRESERVED SHALL NOT BE RAISED OR LOWERED MORE THEN 3\"/>
- THE RPZ SHALL REMAIN PERVIOUS, I.E. GROUND COVER OR TURF AT COMPLETION OF LANDSCAPE DESIGN.
- PROTECTED TREES SHALL BE PROTECTED UNTIL SUCH TIME AS THE CONCRETE WORK CAN BE STAKED TO DETERMINE ITS DISTANCE FROM SIGNIFICANT TREES. (IF FOUND THAT THE CONCRETE WORK WILL BE CLOSER THAN 5\", THE CONTRACTOR WILL MEET WITH REPRESENTATIVES OF THE ENVIRONMENTAL REVIEW DEPARTMENT TO MINIMIZE IMPACT.)
- CONTRACTOR TO UPDATE TREE PRESERVATION PLAN FOR CHANGES DURING CONSTRUCTION AND NOTIFY ENGINEER ACCORDINGLY. THE REVISED TREE PRESERVATION PLAN WILL BE RESUBMITTED AND APPROVED BY THE CITY OF SAN ANTONIO ARBORIST DEPARTMENT UPON FINAL ACCEPTANCE OF ALL SUBDIVISION IMPROVEMENTS.

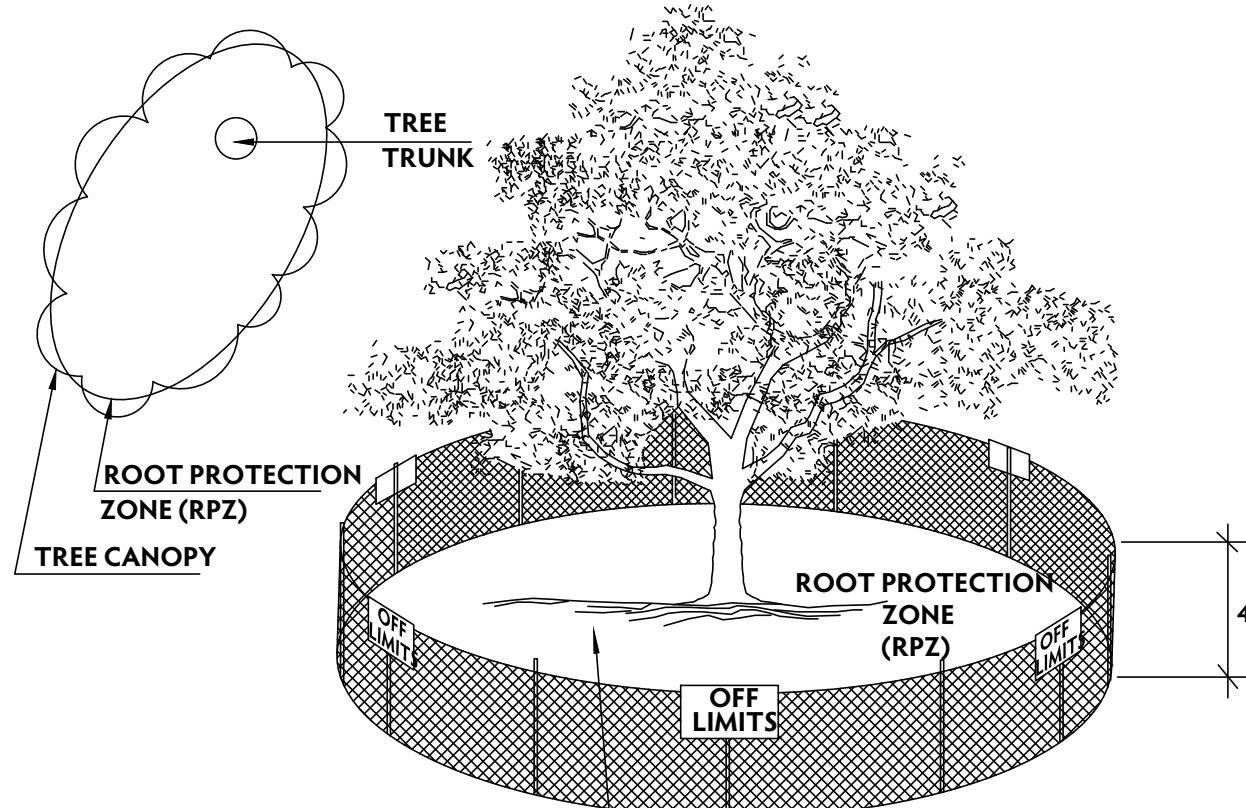

3\"/>

- NOTE:
- THE FENCING SHOWN ABOVE IS DIAGRAMATIC ONLY AND WILL CONFORM TO THE DRIP LINE AND LIMITED TO PROJECT BOUNDARY.
 - FOR ACCEPTABLE FENCING MATERIALS SEE SPECIFICATIONS.

1.1.2

LEVEL I & FENCE PROTECTION

N. T. S.

MATCHLINE C - SEE THIS SHEET

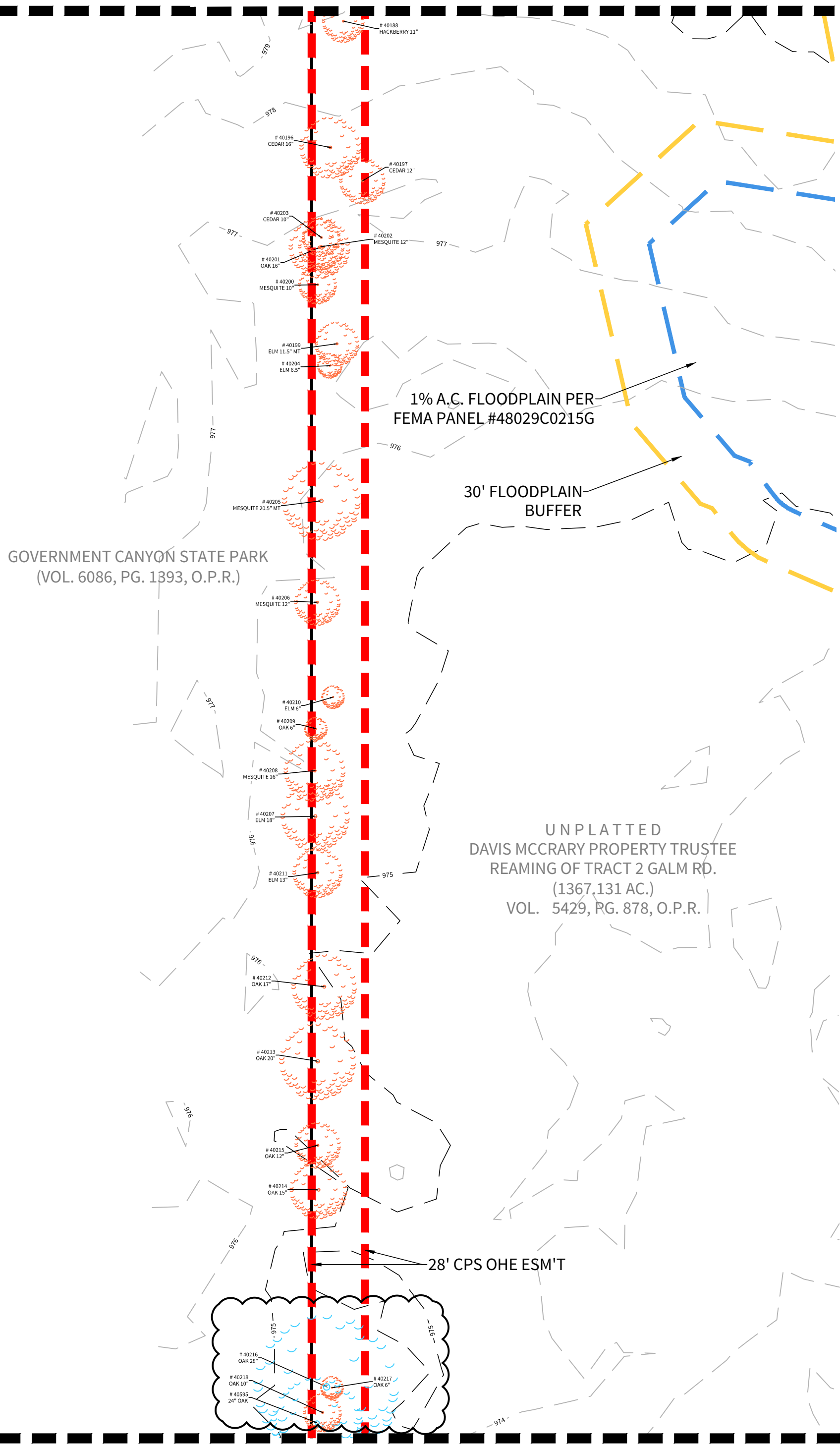

MATCHLINE B - SEE SHEET TPP-3

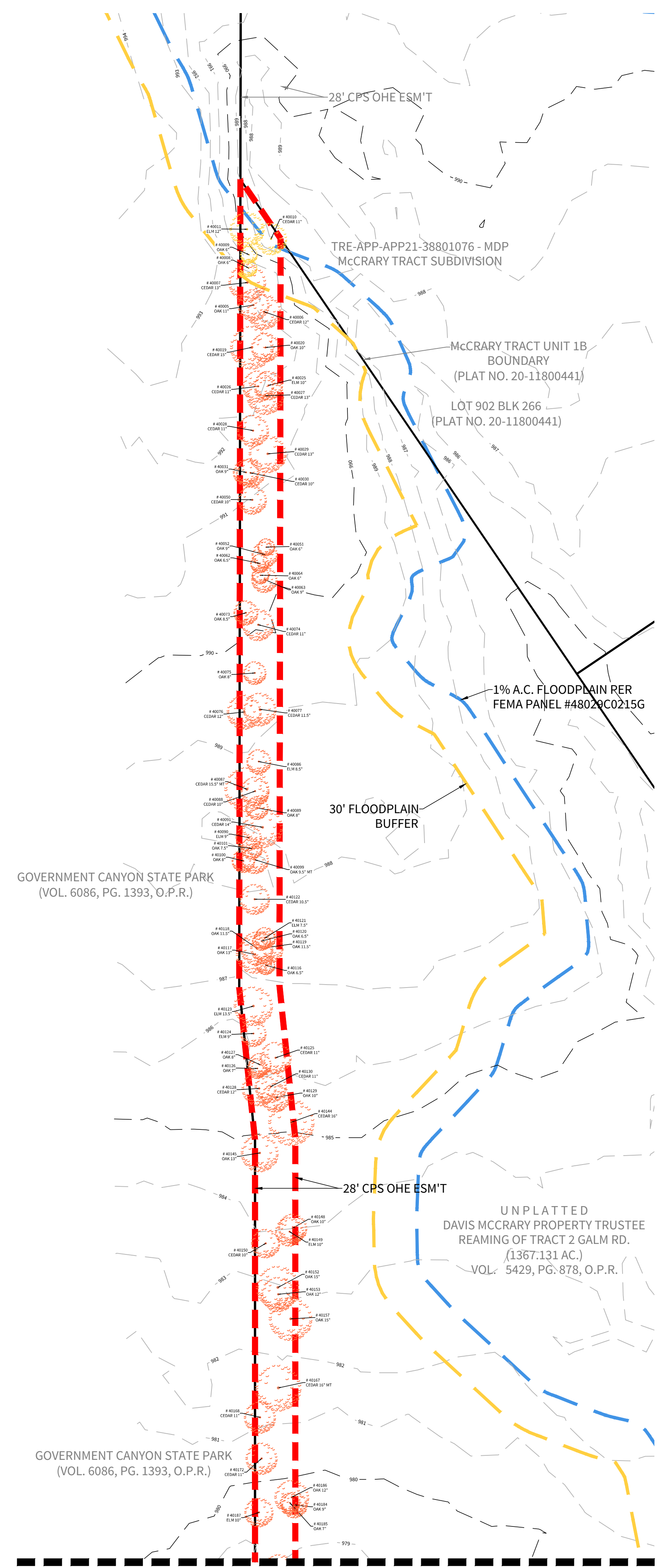

MATCHLINE C - SEE THIS SHEET

CUDEENGINEERS.COM

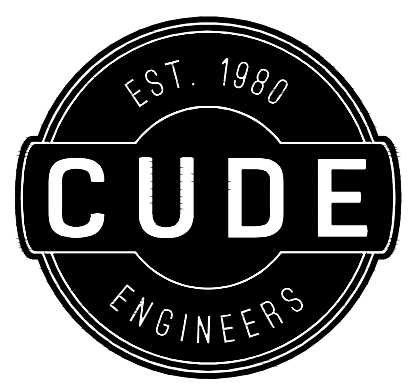

4122 Pond Hill Road, Suite 101
San Antonio, Texas 78231
P:(210) 681.2951 F:(210) 523.7112

MCCRARY TRACT UNIT 3

TREE PRESERVATION PLAN

DATE

10/13/2021

PROJECT NO.
02142.631

DRAWN BY
JRT/MAT/NNR

CHECKED BY
JAM/SWM

REVISIONS

- 10/06/2021 - COMBINED CPS OHE TREE PLAN
- 10/06/2021 - REVISE TREE #40216 TO 2'-28\"/>
-
-
-
-
-
-
-

CUDE ENGINEERS

TBPE No. 455
TBPLS No. 10048500

LAND-PLAT
20-11800554

SAWS JOB NO.

TPP-4

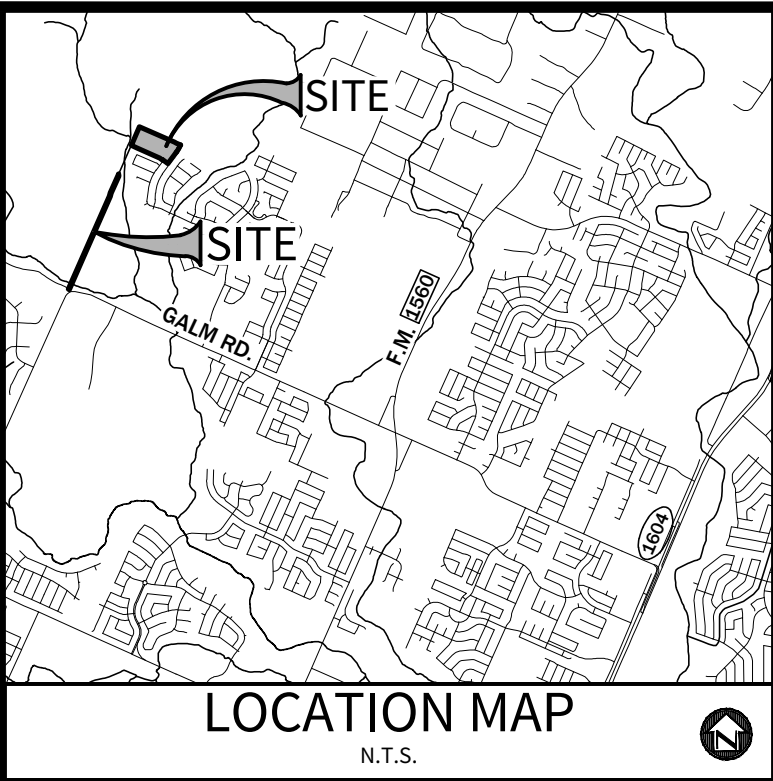

OWNER/DEVELOPER:

HDC DAVIS RANCH II, LLC
CONTACT PERSON: BRIAN N. SIMS
45 NE LOOP 410 SUITE 225
SAN ANTONIO, TX 78216
TEL: (210) 838-6784

CIVIL ENGINEER:

M.W. CUDE ENGINEERS, L.L.C.
CONTACT PERSON: JEFFREY MCKINNIE, P.E.
4122 POND HILL ROAD, SUITE 101
SAN ANTONIO, TX 78231
TEL: (210) 681-2951
FAX: (210) 523-7112

TREE PRESERVATION REQUIREMENTS & CALCULATION	
TREES WITHIN CURRENT 100 YEAR FLOODPLAIN	
SIGNIFICANT FP TREES REMOVED	335"
SIGNIFICANT FP TREES SAVED	443"
TOTAL SIGNIFICANT FP TREES	778"
(SIGNIFICANT FP PRESERVATION (80% MINIMUM)	443 SAVED / 778 TOTAL = 56.94%
INCHES TO MITIGATE (SIGNIFICANT)	180"
HERITAGE FP TREES REMOVED	78"
HERITAGE FP TREES SAVED	31"
TOTAL HERITAGE TREES	109"
PRESERVATION (100% MIN.)	28.44%
INCHES TO MITIGATE (3:1, 1:1 MESQUITE & HACKBERRY)	234"
TREES WITHIN ENVIRONMENTALLY SENSITIVE AREAS (ESA)	
SIGNIFICANT ESA TREES REMOVED	264"
SIGNIFICANT ESA TREES SAVED	245"
HERITAGE ESA TREES REMOVED	0"
HERITAGE ESA TREES SAVED	30"
TOTAL ESA TREES REMOVED	264"
TOTAL ESA TREES SAVED	275"
ESA SIGNIFICANT PRESERVATION (80% MINIMUM)	245 SAVED / 509 TOTAL = 48.13%
INCHES TO MITIGATE (SIGNIFICANT)	162"
SMALL SIGNIFICANT TREES (OUTSIDE FLOODPLAIN & ESA)	
EXEMPT TREES REMOVED (ROW)	49"
EXEMPT TREES SAVED (ROW)	0"
EXEMPT TREES REMOVED (EASEMENTS)	22"
EXEMPT TREES SAVED (EASEMENTS)	0"
NON EXEMPT TREES REMOVE	127"
NON EXEMPT TREES SAVED	17"
TOTAL TREES (EXCLUDING ROW & EASEMENTS)	144"
PRESERVATION (35% MIN)	11.81%
REQUIRED TREES SAVED (35%)	51"
TOTAL TREES SAVED	17"
LARGE SIGNIFICANT TREES (OUTSIDE FLOODPLAIN & ESA)	
EXEMPT TREES REMOVED (ROW)	2164"
EXEMPT TREES SAVED (ROW)	0"
EXEMPT TREES REMOVED (EASEMENTS)	3177"
EXEMPT TREES SAVED (EASEMENTS)	8"
NON EXEMPT TREES REMOVE	5633"
NON EXEMPT TREES SAVED	1687"
TOTAL TREES (EXCLUDING ROW & EASEMENTS)	7320"
PRESERVATION (35% MIN)	23.05%
REQUIRED TREES SAVED (35%)	2562"
TOTAL TREES SAVED	1687"
HERITAGE TREES (OUTSIDE FLOODPLAIN & ESA)	
EXEMPT TREES REMOVED (ROW)	385"
TOTAL TREES REMOVED (EXCLUDING ROW)	756"
TREES SAVED	188"
TOTAL TREES	944"
PRESERVATION (100% MIN.)	19.92%
INCHES TO MITIGATE (3:1, 1:1 MESQUITE & HACKBERRY)	2268"
MITIGATION	
NONFLOODPLAIN SIGNIFICANT REQUIRED PRESERVATION	1949 SAVED / 7973 TOTAL = 24.45%
INCHES TO MITIGATE (NONFLOODPLAIN SIGNIFICANT)	842"
INCHES TO MITIGATE (NONFLOODPLAIN, ESA, FLOODPLAIN, HERITAGE)	3686"
REQUIRED PLANTED CANOPY	237"
ADDITIONAL PLANTED CANOPY (3" DIA./TREE)	711"
MITIGATION PROVIDED	948"
MITIGATION FUND PAYMENT (\$200/IN)	\$ 547,600

TREE CANOPY REQUIREMENTS & CALCULATIONS		
DESCRIPTION	CALCULATION	AREA (S.F.)
SITE AREA		18.8 Ac.
POST CONSTRUCTION CANOPY REQUIRED		818,928 S.F. x 38%
PRESERVED HERITAGE CANOPY	218 x (875 S.F./16.7")	311,192.64
PRESERVED SIGNIFICANT CANOPY	1687" x (875 S.F. / 16.7")	11,422.16
PRESERVED SURPLUS SIGNIFICANT CANOPY (x0.5)	0" x (875 S.F. / 16.7") x 0.5	88,390.72
PLANTED CANOPY (NO ENERGY CREDIT)	201 TREES x 875 S.F. x 0.9	0.00
PLANTED CANOPY (ENERGY CREDIT)	194 TREES x 875 S.F. x 0.9 x 1.5	158,287.50
PRESERVED CANOPY (ENERGY CREDIT)	0" x (875 S.F. / 16.7") x 0.5	229,162.50
TOTAL CANOPY PROVIDED		0.00
		487,262.88 (59.5%)

SMALL SIGNIFICANT TREE PRESERVATION LIST										
POINT #	SPECIES	EXEMPT (ROW)		FLOODPLAIN		ENV SENS AREA		EASEMENT		NON EXEMPT
		REMOVE	PRESERVE	REMOVE	PRESERVE	REMOVE	PRESERVE	REMOVE	PRESERVE	
183	PERSIMMON	7	0	0	0	0	0	0	0	0
184	PERSIMMON	0	0	0	0	0	0	0	0	0
186	PERSIMMON	8	0	0	0	0	0	0	0	0
1585	PERSIMMON	0	0	0	0	0	0	0	5	0
1634	PERSIMMON	0	0	0	0	0	0	6	0	0
1732	PERSIMMON	0	0	0	0	0	0	0	7	0
1776	PERSIMMON	0	0	0	0	0	0	0	7	0
1882	PERSIMMON	0	0	0	0	0	0	0	5	0
1948	PERSIMMON	0	0	0	0	0	0	0	6	0
1996	PERSIMMON	0	0	0	0	0	0	0	6	0
2205	PERSIMMON	0	0	0	0	0	0	0	8	0
2210	PERSIMMON	0	0	0	0	0	0	0	8	0
2238	PERSIMMON	0	0	0	0	0	0	0	10	0
	PERSIMMON	0	0	0	0	0	0	0	6	0
2243	PERSIMMON	0	0	0	0	0	0	0	10	0
2247	PERSIMMON	0	0	0	0	0	0	0	9	0
2283	PERSIMMON	0	0	0	0	0	0	0	7	0
2412	PERSIMMON	0	0	0	0	0	0	0	6	0
2946	PERSIMMON	0	0	0	0	0	5	0	0	0
2947	PERSIMMON	0	0	0	0	0	5	0	0	0
2979	PERSIMMON	0	0	0	0	0	0	0	6	99
3324	PERSIMMON	5	0	0	0	0	0	0	0	0
3325	PERSIMMON	6	0	0	0	0	0	0	0	0
3328	PERSIMMON	0	0	0	0	0	0	0	0	11
3419	PERSIMMON	5	0	0	0	0	0	0	0	0
3421	PERSIMMON	0	0	0	0	0	0	0	5	0
3985	PERSIMMON	5	0	0	0	0	0	0	0	0
3986	PERSIMMON	7	0	0	0	0	0	0	0	0
12396	PERSIMMON	0	0	0	0	0	0	0	5	0
12400	PERSIMMON	6	0	0	0	0	0	0	0	0
13331	PERSIMMON	0	0	0	0	0	0	0	7	0
13350	PERSIMMON	0	0	0	0	0	6	0	0	0
999999	TOTAL	49	0	0	0	0	22	0	127	17
										280

HERITAGE TREE PRESERVATION LIST										
POINT #	SPECIES	EXEMPT (ROW)		FLOODPLAIN		ENV SENS AREA		EASEMENT		NON EXEMPT
		REMOVE	PRESERVE	REMOVE	PRESERVE	REMOVE	PRESERVE	REMOVE	PRESERVE	
155	OAK	0	0	0	0	0	0	26	0	0
162	PERSIMMON	0	0	0	0	0	0	0	12	198
165	CEDAR	0	0	0	0	0	0	0	36	593
187	OAK	0	0	0	0	0	0	28	0	0
189	OAK	0	0	0	0	0	0	24	0	0
190	OAK	0	0	0	0	0	0	31	0	0
192	OAK	0	0	0	0	0	0	35	0	0
194	OAK	0	0	0	0	0	0	30	0	0
197	OAK	0	0	0	0	0	0	31	0	0
260	OAK	24	0	0	0	0	0	0	0	0
267	OAK	39	0	0	0	0	0	0	0	0
270	OAK	36	0	0	0	0	0	0	0	0
276	OAK	27	0	0	0	0	0	0	0	0
282	OAK	25	0	0	0	0	0	0	0	0
389	OAK	39	0	0	0	0	0	0	0	0
390	OAK	0	0	0	0	0	0	32.5	0	0
391	OAK	0	0	0	0	30	0	0	0	0
392	OAK	0	0	30.5	0	0	0	0	0	0
406	OAK	0	0	0	0	0	0	29.5	0	0
407	OAK	0	0	0	0	0	0	24.5	0	0
408	OAK	0	0	0	0	0	0	30.5	0	0
425	OAK	0	0	0	0	0	24	0	0	0
432	OAK	26	0	0	0	0	0	0	0	0
433	OAK	31	0	0	0	0	0	0	0	0
434	OAK	25.5	0	0	0	0	0	0	0	0
435	OAK	0	0	0	0	0	0	25	0	0
436	OAK	0	0	0	0	0	0	26	0	0
440	OAK	0	0	0	0	0	0	0	30.5	0
441	OAK	0	0	0	0	0	0	0	31	0
442	OAK	0	0	0	0	0	30	0	0	0
1229	OAK	0	0	0	0	0	0	28	0	0
	OAK	27	0	0	0	0	0	0	0	0
1448	CEDAR	0	0	0	0	0	0	30	0	0
1485	CEDAR	0	0	0	0	0	26	0	0	0
1487	CEDAR	29	0	0	0	0	0	0	0	0
1490	OAK	0	0	0	0	0	0	26	0	0
1783	CEDAR	0	0	0	0	0	0	27	0	0
1899	CEDAR	0	0	0	0	0	0	27	0	0
1900	CEDAR	0	0	0	0	0	0	26	0	0
1936	CEDAR	29	0	0	0	0	0	0	0	0
2221	CEDAR	0	0	0	0	0	0	25	0	0
2315	CEDAR	27	0	0	0	0	0	0	0	0
2409	OAK	0	0	0	0	0	0	27	0	0
2413	OAK	0	0	0	0	0	0	37	0	0
2499	OAK	0	0	0	0	0	0	0	24	0
3327	OAK	0	0	0	0	0	34	0	0	0
3387	OAK	0	26	0	0	0	0	0	0	0
3392	OAK	0	26	0	0	0	0	0	0	0
3450	OAK	0	0	0	0	0	0	0	24	0
3458	OAK	0	0	0	0	0	0	28	0	0
3933	OAK	0	26	0	0	0	0	0	0	0
999999	TOTAL	384.5	78	30.5	0	30	114	0	654	157.5
										790

LARGE SIGNIFICANT TREE PRESERVATION LIST											
POINT #	SPECIES	EXEMPT (ROW)	FLOODPLAIN		ENV SENS AREA		EASEMENT		NON EXEMPT		SHADE VALUE
		REMOVE	REMOVE	PRESERVE	REMOVE	PRESERVE	REMOVE	PRESERVE	REMOVE	PRESERVE	
3973	OAK	8	0	0	0	0	0	0	0	0	0
3974	OAK	14	0	0	0	0	0	0	0	0	0
3975	OAK	6	0	0	0	0	0	0	0	0	0
3976	OAK	8	0	0	0	0	0	0	0	0	0
3977	OAK	9	0	0	0	0	0	0	0	0	0
3978	OAK	9	0	0	0	0	0	0	0	0	0
3979	OAK	15	0	0	0	0	0	0	0	0	0
3980	OAK	11	0	0	0	0	0	0	0	0	0
3981	OAK	15	0	0	0	0	0	0	0	0	0
3982	OAK	16	0	0	0	0	0	0	0	0	0
3983	OAK	11	0	0	0	0	0	0	0	0	0
3984	OAK	6	0	0	0	0	0	0	0	0	0
3987	OAK	9	0	0	0	0	0	0	0	0	0
3988	OAK	13	0	0	0	0	0	0	0	0	0
3989	CEDAR	20	0	0	0	0	0	0	0	0	0
3990	OAK	0	0	0	0	0	6	0	0	0	0
3991	OAK	0	0	0	0	0	0	0	0	7	367
3992	OAK	0	0	0	0	0	0	0	0	6	314
3994	OAK	0	0	0	0	0	0	0	0	6	314
3995	OAK	0	0	0	0	0	0	0	0	8	419
3996	OAK	0	0	0	0	0	7	0	0	0	0
3997	OAK	0	0	0	0	0	6	0	0	0	0
3998	OAK	7	0	0	0	0	0	0	0	0	0
3999	OAK	0	0	0	0	0	0	0	14	0	0
12378	CEDAR	17	0	0	0	0	0	0	0	0	0
12382	CEDAR	14	0	0	0	0	0	0	0	0	0
12383	CEDAR	15	0	0	0	0	0	0	0	0	0
12384	CEDAR	12	0	0	0	0	0	0	0	0	0
12385	CEDAR	0	0	0	0	0	20	0	0	0	0
12386	MESQUITE	0	0	0	0	0	10	0	0	0	0
12387	MESQUITE	0	0	0	0	0	0	0	10	0	0
12388	CEDAR	0	0	0	0	0	0	0	10	0	0
12389	CEDAR	0	0	0	0	0	0	0	10	0	0
12390	CEDAR	0	0	0	0	0	0	0	16	0	0
12391	CEDAR	10	0	0	0	0	0	0	0	0	0
12392	MESQUITE	15	0	0	0	0	0	0	0	0	0
12393	OAK	0	0	0	0	0	14	0	0	0	0
12394	OAK	0	0	0	0	0	7	0	0	0	0
12395	OAK	0	0	0	0	0	0	0	18	0	0
12397	MESQUITE	0	0	0	0	0	13	0	0	0	0
12398	CEDAR	0	0	0	0	0	0	0	11	0	0
12399	OAK	0	0	0	0	0	0	0	13	0	0
13305	OAK	0	0	0	0	0	0	0	17	0	0
13306	OAK	0	0	0	0	0	0	0	10	0	0
13307	OAK	0	0	0	0	0	0	0	16	0	0
13308	OAK	0	0	0	0	0	0	0	19	0	0
13309	OAK	0	0	0	0	0	0	0	19	0	0
13310	OAK	0	0	0	0	0	0	0	15	0	0
13311	OAK	0	0	0	0	0	0	0	11	0	0
13312	OAK	0	0	0	0	0	0	0	7	0	0
13313	MESQUITE	0	0	0	0	0	0	0	15	0	0
13314	OAK	0	0	0	0	0	0	0	6	0	0
13315	OAK	0	0	0	0	0	0	0	7	0	0
13316	OAK	0	0	0	0	0	0	0	7	0	0
13317	OAK	0	0	0	0	0	0	0	8	0	0
13318	OAK	0	0	0	0	0	0	0	9	0	0
13319	ELM	0	0	0	0	0	0	0	9	0	0
13320	CEDAR	0	0	0	0	0	0	0	0	15	247
13321	ELM	0	0	0	0	0	0	0	17	0	0
13322	OAK	0	0	0	0	0	0	0	8	0	0
13323	OAK	0	0	0	0	0	0	0	12	0	0
13324	OAK	0	0	0	0	0	0	0	13	0	0
13325	ELM	0	0	0	0	0	0	0	6	0	0
13326	CEDAR	0	0	0	0	0	0	0	22	0	0
13327	CEDAR	0	0	0	0	0	0	0	10	0	0
13328	CEDAR	0	0	0	0	0	0	0	10	0	0
13330	MESQUITE	0	0	0	0	0	0	0	11	0	0
13332	MESQUITE	0	0	0	0	0	0	0	13	0	0
13351	OAK	0	0	0	0	0	12	0	0	0	0
13366	OAK	0	0	0	0	0	9	0	0	0	0
13368	OAK	0	0	0	0	0	12	0	0	0	0
13369	OAK	0	0	0	0	0	19	0	0	0	0
13370	OAK	0	0	0	0	0	8	0	0	0	0
13371	OAK	0	0	0	0	0	12	0	0	0	0
13372	OAK	0	0	0	0	0	13	0	0	0	0
13373	OAK	0	0	0	0	0	7	0	0	0	0
13374	OAK	0	0	0	0	0	7	0	0	0	0
13375	OAK	0	0	0	0	0	7	0	0	0	0
999999	TOTAL	2164	113	474	240	245	1600	8	5633	1697	7721

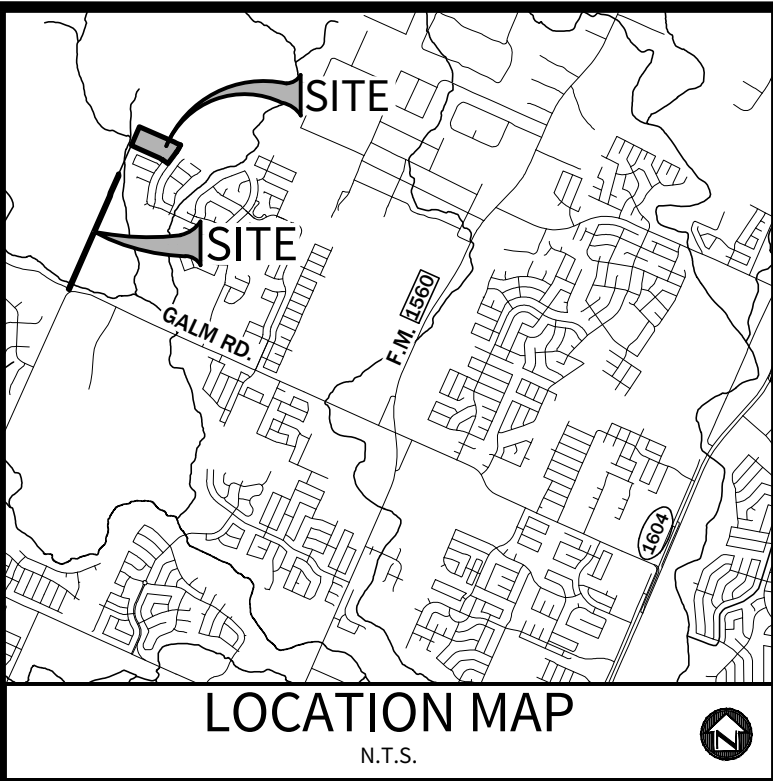

OWNER/DEVELOPER:
HDC DAVIS RANCH II, LLC
CONTACT PERSON: BRYAN N. SIMS
45 NE LOOP 410 SUITE 225
SAN ANTONIO, TX 78216
TEL: (210) 838-6784

CIVIL ENGINEER:
M.W. CUDE ENGINEERS, L.L.C.
CONTACT PERSON: JEFFREY MCKINNIE, P.E.
4122 POND HILL ROAD, SUITE 101
SAN ANTONIO, TX 78231
TEL: (210) 681-2951
FAX: (210) 523-7112

LARGE SIGNIFICANT TREE PRESERVATION LIST												
POINT #	SPECIES	EXEMPT (ROW)	FLOODPLAIN		ENV SENS AREA		EASEMENT		NON EXEMPT		SHADE VALUE	
		REMOVE	REMOVE	PRESERVE	REMOVE	PRESERVE	REMOVE	PRESERVE	REMOVE	PRESERVE		
110	OAK	0	0	0	0	0	6	0	0	0	0	0
111	OAK	0	0	0	0	0	9	0	0	0	0	0
112	OAK	0	0	0	0	0	9	0	0	0	0	0
114	OAK	0	0	0	0	0	6	0	0	0	0	0
149	OAK	0	0	0	0	0	0	0	7	0	0	0
150	OAK	0	0	0	0	0	0	0	8	0	0	0
151	OAK	0	0	0	0	0	0	0	6	0	0	0
152	OAK	0	0	0	0	0	0	0	8	0	0	0
153	OAK	0	0	0	0	0	0	0	7	0	0	0
154	ELM	0	0	0	0	0	0	0	14	0	0	0
156	ELM	0	0	0	0	0	0	0	11	0	0	0
157	OAK	0	0	0	0	0	0	0	9	0	0	0
158	HACKBERRY	0	0	0	0	0	0	0	10	0	0	0
159	HACKBERRY	0	0	0	0	0	0	0	16	0	0	0
160	HACKBERRY	0	0	0	0	0	0	0	11	0	0	0
161	MESQUITE	0	0	0	0	0	0	0	15	0	0	0
163	MESQUITE	0	0	0	0	0	0	0	10	0	0	0
164	HACKBERRY	0	0	0	0	0	0	0	0	11	576	
166	HACKBERRY	0	0	0	0	0	0	0	10	0	0	0
175	MESQUITE	0	0	0	0	0	12	0	0	0	0	0
176	MESQUITE	0	0	0	0	0	11	0	0	0	0	0
179	MESQUITE	0	0	0	0	0	12	0	0	0	0	0
180	MESQUITE	0	0	0	0	0	0	0	0	10	329	
181	MESQUITE	0	0	0	0	0	0	0	12	0	0	0
182	HACKBERRY	0	0	0	0	0	0	0	11	0	0	0
185	HACKBERRY	0	0	0	0	0	0	0	15	0	0	0
188	OAK	0	0	0	0	0	0	0	11	0	0	0
191	OAK	0	0	0	0	0	0	0	19	0	0	0
195	OAK	0	0	0	0	0	0	0	21	0	0	0
196	OAK	0	0	0	0	0	0	0	10	0	0	0
199	OAK	0	0	0	0	0	0	0	11	0	0	0
200	OAK	0	0	0	0	0	0	0	8	0	0	0
202	OAK	22	0	0	0	0	0	0	0	0	0	0
203	OAK	22	0	0	0	0	0	0	0	0	0	0
204	OAK	12	0	0	0	0	0	0	0	0	0	0
205	OAK	14	0	0	0	0	0	0	0	0	0	0
206	OAK	11	0	0	0	0	0	0	0	0	0	0
215	OAK	0	0	0	0	0	0	0	11	0	0	0
239	OAK	0	0	0	0	0	10	0	0	0	0	0
240	OAK	0	0	0	0	0	9	0	0	0	0	0
241	OAK	0	0	0	0	0	0	0	8	0	0	0
242	OAK	0	0	0	0	0	15	0	0	0	0	0
243	OAK	0	0	0	0	0	0	0	8	0	0	0
244	OAK	0	0	0	0	0	0	0	12	0	0	0
245	OAK	0	0	0	0	0	0	0	6	0	0	0
246	OAK	11	0	0	0	0	0	0	0	0	0	0
247	OAK	7	0	0	0	0	0	0	0	0	0	0
248	OAK	8	0	0	0	0	0	0	0	0	0	0
249	OAK	14	0	0	0	0	0	0	0	0	0	0
250	OAK	10	0	0	0	0	0	0	0	0	0	0
251	OAK	16	0	0	0	0	0	0	0	0	0	0
252	OAK	18	0	0	0	0	0	0	0	0	0	0
253	OAK	14	0	0	0	0	0	0	0	0	0	0
254	OAK	19	0	0	0	0	0	0	0	0	0	0
255	OAK	9	0	0	0	0	0	0	0	0	0	0
256	OAK	8	0	0	0	0	0	0	0	0	0	0
257	OAK	9	0	0	0	0	0	0	0	0	0	0
258	OAK	9	0	0	0	0	0	0	0	0	0	0
259	OAK	9	0	0	0	0	0	0	0	0	0	0
261	OAK	0	0	0	0	0	8	0	0	0	0	0
262	OAK	0	0	0	0	0	18	0	0	0	0	0
263	OAK	0	0	0	0	0	11	0	0	0	0	0
264	OAK	0	0	0	0	0	0	0	10	0	0	0
265	ELM	0	0	0	0	0	0	0	8	0	0	0
266	OAK	6	0	0	0	0	0	0	0	0	0	0
268	OAK	19	0	0	0	0	0	0	0	0	0	0
269	OAK	16	0	0	0	0	0	0	0	0	0	0
271	OAK	0	0	0	0	0	0	0	15	0	0	0
272	ELM	0	0	0	0	0	0	0	11	0	0	0
273	ELM	0	0	0	0	0	0	0	11	0	0	0
274	OAK	0	0	0	0	0	0	0	22	0	0	0
275	OAK	0	0	0	0	0	16	0	0	0	0	0
277	OAK	8	0	0	0	0	0	0	0	0	0	0
278	OAK	10	0	0	0	0	0	0	0	0	0	0
279	OAK	11	0	0	0	0	0	0	0	0	0	0
280	OAK	10	0	0	0	0	0	0	0	0	0	0
281	OAK	9	0	0	0	0	0	0	0	0	0	0
283	OAK	11	0	0	0	0	0	0	0	0	0	0
284	OAK	7	0	0	0	0	0	0	0	0	0	0
285	OAK	11	0	0	0	0	0	0	0	0	0	0
286	OAK	10	0	0	0	0	0	0	0	0	0	0
287	OAK	14	0	0	0	0	0	0	0	0	0	0
1217	OAK	0	0	0	0	0	0	0	10	0	0	0
1219	OAK	0	0	0	0	0	0	0	17	0	0	0
1221	OAK	0	0	0	0	0	0	0	11	0	0	0
1223	OAK	0	0	0	0	0	0	0	8	0	0	0
1224	OAK	0	0	0	0	0	0	0	8	0	0	0
1225	OAK	0	0	0	0	0	0	0	6	0	0	0
1226	OAK	0	0	0	0	0	0	0	8	0	0	0
1227	OAK	0	0	0	0	0	0	0	8	0	0	0
1228	OAK	0	0	0	0	0	0	0	12	0	0	0
1230	OAK	0	0	0	0	0	0	0	10	0	0	0
1231	CEDAR	10	0	0	0	0	0	0	0	0	0	0
1232	OAK	0	0	0	0	0	0	0	8	0	0	0
1233	OAK	14	0	0	0	0	0	0	0	0	0	0
1234	OAK	0	0	0	0	0	10	0	0	0	0	0
1235	OAK	12	0	0	0	0	0	0	0	0	0	0
1236	ELM	11	0	0	0	0	0	0	0	0	0	0
1237	OAK	9	0	0	0	0	0	0	0	0	0	0
1238	CEDAR	13	0	0	0	0	0	0	0	0	0	0
1401	OAK	0	0	0	0	0	0	0	9	0	0	0
1402	OAK	0	0	0	0	0	0	0	11	0	0	0
1403	ELM	0	0	0	0	0	0	0	8	0	0	0
1404	OAK	0	0	0	0	0	0	0	13	0	0	0
1405	OAK	0	0	0	0	0	0	0	7	0	0	0

LARGE SIGNIFICANT TREE PRESERVATION LIST												
POINT #	SPECIES	EXEMPT (ROW)	FLOODPLAIN		ENV SENS AREA		EASEMENT		NON EXEMPT		SHADE VALUE	
		REMOVE	REMOVE	PRESERVE	REMOVE	PRESERVE	REMOVE	PRESERVE	REMOVE	PRESERVE		
1406	ELM	0	0	0	0	0	0	0	8	0	0	
1407	OAK	0	0	0	0	0	0	0	8	0	0	
1408	OAK	0	0	0	0	0	0	0	10	0	0	
1409	OAK	0	0	0	0	0	0	0	9	0	0	
1410	ELM	0	0	0	0	0	0	0	6	0	0	
1411	ELM	0	0	0	0	0	0	0	7	0	0	
1412	ELM	0	0	0	0	0	0	0	8	0	0	
1413	ELM	0	0	0	0	0	0	0	9	0	0	
1414	ELM	0	0	0	0	0	0	0	7	0	0	
1415	OAK	0	0	0	0	0	0	0	6	0	0	
1416	ELM	0	0	0	0	0	0	0	6	0	0	
1417	ELM	0	0	0	0	0	0	0	7	0	0	
1418	OAK	0	0	0	0	0	0	0	14	0	0	
1419	OAK	0	0	0	0	0	0	0	12	0	0	
1420	ELM	0	0	0	0	0	0	0	9	0	0	
1421	OAK	0	0	0	0	0	0	0	6	0	0	
1422	OAK	0	0	0	0	0	0	0	14	0	0	
1423	OAK	0	0	0	0	0	0	0	12	0	0	
1424	OAK	0	0	0	0	0	7	0	0	0	0	
1425	OAK	8	0	0	0	0	0	0	0	0	0	
1426	OAK	16	0	0	0	0	0	0	0	0	0	
1427	ELM	6	0	0	0	0	0	0	0	0	0	
1428	OAK	9	0	0	0	0	0	0	0	0	0	
1429	OAK	0	0	0	0	0	11	0	0	0	0	
1430	CEDAR	0	0	0	0	0	12	0	0	0	0	
1431	OAK	18	0	0	0	0	0	0	0	0	0	
1433	CEDAR	0	0	0	0	0	0	0	10	0	0	
1435	CEDAR	0	0	0	0	0	0	0	12	0	0	
1436	CEDAR	0	0	0	0	0	0	0	14	0	0	
1437	CEDAR	0	0	0	0	0	0	0	12	0	0	
1444	OAK	0	0	0	0	0	0	0	16	0	0	
1445	OAK	0	0	0	0	0	0	0	10	0	0	
1449	CEDAR	0	0	0	0	0	0	0	0	13	214	
1450	CEDAR	0	0	0	0	0	0	0	0	13	214	
1451	HACKBERRY	0	0	0	0	0	0	0	10	0	0	
1452	CEDAR	0	0	0	0	0	0	0	19	0	0	
1453	MESQUITE	0	0	0	0	0	0	0	11	0	0	
1454	MESQUITE	0	0	0	0	0	0	0	13	0	0	
1455	CEDAR	0	0	0	0	0	0	0	0	11	181	
1456	CEDAR	0	0	0	0	0	0	0	0	11	181	
1457	CEDAR	0	0	0	0	0	0	0	10	0	0	
1468	HACKBERRY	0	0	0	0	0	16	0	0	0	0	
1470	CEDAR	0	0	0	0	0	11	0	0	0	0	
1471	CEDAR	0	0	0	0	0	17	0	0	0	0	
1473	MESQUITE	0	0	0	0	0	14	0	0	0	0	
1486	CEDAR	12	0	0	0	0	0	0	0	0	0	
1488	CEDAR	22	0	0	0	0	0	0	0	0	0	
1489	OAK	9	0	0	0	0	0	0	0	0	0	
1491	OAK	10	0	0	0	0	0	0	0	0	0	
1492	CEDAR	0	0	0	0	0	15	0	0	0	0	
1493	CEDAR	0	0	0	0	0	0	0	11	0	0	
1494	CEDAR	19	0	0	0	0	0	0	0	0	0	
1495	OAK	14	0	0	0	0	0	0	0	0	0	
1496	OAK	13	0	0	0	0	0	0	0	0	0	
1497	CEDAR	14	0	0	0	0	0	0	0	0	0	
1498	CEDAR	11	0	0	0	0	0	0	0	0	0	
1499	CEDAR	10	0	0	0	0	0	0	0	0	181	
1500	OAK	17	0	0	0	0	0	0	0	0	0	
1501	OAK	0	0	0	0	0	0	0	10	0	0	
1502	OAK	0	0	0	0	0	0	0	7	0	0	
1503	OAK	0	0	0	0	0	0	0	16	0	0	
1504	OAK	0	0	0	0	0	12	0	0	0	0	
1505	OAK	0	0	0	0	0	0	0	10	0	0	
1506	OAK	0	0	0	0	0	0	0	16	0	0	
1507	OAK	0	0	0	0	0	0	0	18	0	0	
1508	OAK	0	0	0	0	0	0	0	6	0	0	
1509	OAK	0	0	0	0	0	0	0	6	0	181	
1510	OAK	0	0	0	0	0	0	0	7	0	0	
1511	OAK	0	0	0	0	0	0	0	8	0	181	
1512	OAK	0	0	0	0	0	0	0	7	0	0	
1513	OAK	0	0	0	0	0	0	0	7	0	0	
1514	OAK	0	0	0	0	0	0	0	21	0	0	
1515	CEDAR	0	0	0	0	0	0	0	13	0	0	
1516	CEDAR	14	0	0	0	0	0	0	0	0	0	
1517	CEDAR	11	0	0	0	0	0	0	0	0	0	
1518	CEDAR	12	0	0	0	0	0	0	0	0	0	
1519	CEDAR	0	0	0	0	0	16	0	0	0	0	
1520	CEDAR	12	0	0	0	0	0	0	0	0	214	
1521	CEDAR	11	0	0	0	0	0	0	0	0	0	
1522	CEDAR	0	0	0	0	0	0	0	19	0	0	
1523	ELM	0	0	0	0	0	0	0	12	0	0	
1524	CEDAR	0	0	0	0	0	0	0	10	0	0	
1525	CEDAR	0	0	0	0	0	0	0	18	0	0	
1526	CEDAR	0	0	0	0	0	0	0	15	0	0	
1527	CEDAR	0	0	0	0	0	0	0	12	0	0	
1528	CEDAR	0	0	0	0	0	0	0	17	0	0	
1529	CEDAR	0	0	0	0	0	0	0	21	0	0	
1530	CEDAR	0	0	0	0	0	0	0	10	0	0	
1550	CEDAR	0	0	0	0	0	0	0	10	0	0	
1554	OAK	0	0	0	0	0	0	0	10	0	0	
1557	OAK	0	0	0	0	0	0	0	6	0	0	
1558	OAK	0	0	0	0	0	0	0	11	0	0	
1578	CEDAR	0	0	0	0	0	0	0	12	0	0	
1579	CEDAR	0	0	0	0	0	0	0	15	0	0	
1580	OAK	0	0	0	0	0	0	0	14	0	0	
1581	OAK	0	0	0	0	0	0	0	12	0	0	
1582	CEDAR	0	0	0	0	0	0	0	11	0	181	
1583	OAK	0	0	0	0	0	0	0	10	0	0	
1584	OAK	0	0	0	0	0	0	0	15	0	0	
1586	OAK	0	0	0	0	0	0	0	10	0	0	
1587	OAK	0	0	0	0	0	0	0	10	0	0	
1588	OAK	0	0	0	0	0	0	0	10	0	0	
1589	OAK	0	0	0	0	0	0	0	15	0	0	
1590	ELM	0	0	0	0	0	0	0	7	0	0	
1591	ELM	0	0	0	0	0	0	0	7	0	0	

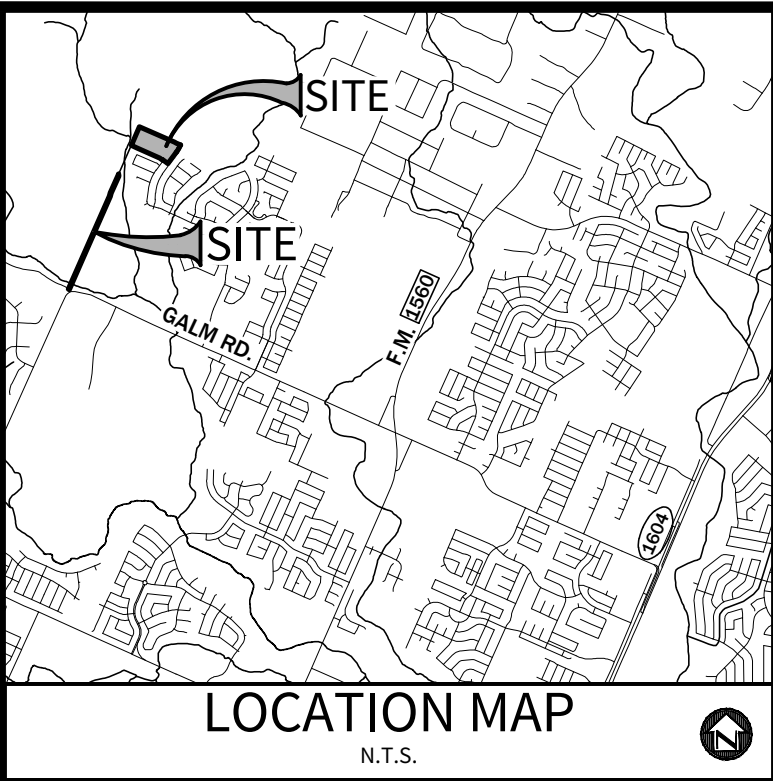

OWNER/DEVELOPER:
HDC DAVIS RANCH II, LLC
CONTACT PERSON: BRYAN N. SIMS
45 NE LOOP 410 SUITE 225
SAN ANTONIO, TX 78216
TEL: (210) 838-6784

CIVIL ENGINEER:
M.W. CUDE ENGINEERS, L.L.C.
CONTACT PERSON: JEFFREY MCKINNIE, P.E.
4122 POND HILL ROAD, SUITE 101
SAN ANTONIO, TX 78231
TEL: (210) 681-2951
FAX: (210) 523-7112

LARGE SIGNIFICANT TREE PRESERVATION LIST													
POINT #	SPECIES	EXEMPT (ROW) REMOVE	FLOODPLAIN REMOVE PRESERVE	ENV SENS AREA REMOVE PRESERVE	EASEMENT REMOVE PRESERVE	NON EXEMPT REMOVE PRESERVE	SHADE VALUE						
1592	OAK	0	0	0	0	0	8	0	0	0	0	0	0
1593	OAK	0	0	0	0	0	6	0	0	0	0	0	0
1594	ELM	0	0	0	0	0	7	0	0	0	0	0	0
1595	OAK	0	0	0	0	0	8	0	0	0	0	0	0
1596	ELM	0	0	0	0	0	8	0	0	0	0	0	0
1597	CEDAR	0	0	0	0	0	11	0	0	0	0	0	0
1598	CEDAR	0	0	0	0	0	10	0	0	0	0	0	0
1600	CEDAR	0	0	0	0	0	14	0	0	0	0	0	0
1601	OAK	0	0	0	0	15	0	0	0	0	0	0	0
1605	OAK	0	0	0	0	7	0	0	0	0	0	0	0
1606	OAK	0	0	0	0	0	9	0	0	0	0	0	0
1607	OAK	0	0	0	0	0	7	367	0	0	0	0	0
1608	CEDAR	0	0	0	0	0	11	7	0	0	0	0	0
1609	CEDAR	0	0	0	0	0	10	0	0	0	0	0	0
1610	CEDAR	0	0	0	0	0	11	0	0	0	0	0	0
1611	OAK	0	0	0	0	0	10	0	0	0	0	0	0
1612	CEDAR	0	0	0	0	0	10	0	0	0	0	0	0
1613	OAK	0	0	0	0	0	12	0	0	0	0	0	0
1614	OAK	0	0	0	0	0	7	0	0	0	0	0	0
1615	OAK	0	0	0	0	0	15	0	0	0	0	0	0
1616	MESQUITE	12	0	0	0	0	0	0	0	0	0	0	0
1617	OAK	0	0	0	0	0	10	0	0	0	0	0	0
1618	OAK	0	0	0	0	0	13	0	0	0	0	0	0
1619	OAK	0	0	0	0	0	13	0	0	0	0	0	0
1620	OAK	0	0	0	0	0	12	0	0	0	0	0	0
1621	MESQUITE	0	0	0	0	0	14	0	0	0	0	0	0
1622	CEDAR	0	0	0	0	0	23	0	0	0	0	0	0
1623	CEDAR	0	0	0	0	0	11	0	0	0	0	0	0
1624	CEDAR	0	0	0	0	0	10	0	0	0	0	0	0
1625	MESQUITE	0	0	0	0	0	16	0	0	0	0	0	0
1631	MESQUITE	0	0	0	0	11	0	0	0	0	0	0	0
1632	MESQUITE	0	0	0	0	14	0	0	0	0	0	0	0
1633	CEDAR	0	0	0	0	17	0	0	0	0	0	0	0
1636	HACKBERRY	0	0	0	0	14	0	0	0	0	0	0	0
1651	OAK	0	0	0	0	0	10	0	0	0	0	0	0
1652	OAK	0	0	0	0	0	10	0	0	0	0	0	0
1653	OAK	0	0	0	0	0	10	0	0	0	0	0	0
1654	OAK	0	0	0	0	0	8	0	0	0	0	0	0
1655	OAK	0	0	0	0	0	8	0	0	0	0	0	0
1656	OAK	0	0	0	0	0	17	0	0	0	0	0	0
1657	OAK	0	0	0	0	0	0	12	629	0	0	0	0
1703	CEDAR	0	0	0	0	12	0	0	0	0	0	0	0
1704	CEDAR	0	0	0	0	16	0	0	0	0	0	0	0
1705	CEDAR	0	0	0	0	0	13	0	0	0	0	0	0
1706	OAK	0	0	0	0	0	19	0	0	0	0	0	0
1707	OAK	0	0	0	0	0	20	0	0	0	0	0	0
1708	ELM	0	0	0	0	0	11	0	0	0	0	0	0
1709	OAK	0	0	0	0	0	10	0	0	0	0	0	0
1710	OAK	0	0	0	0	0	14	0	0	0	0	0	0
1711	OAK	0	0	0	0	0	8	0	0	0	0	0	0
1712	OAK	0	0	0	0	0	11	0	0	0	0	0	0
1713	OAK	0	0	0	0	0	11	0	0	0	0	0	0
1714	OAK	0	0	0	0	0	11	0	0	0	0	0	0
1715	OAK	0	0	0	0	0	12	0	0	0	0	0	0
1716	ELM	0	0	0	0	0	11	0	0	0	0	0	0
1717	OAK	0	0	0	0	0	14	0	0	0	0	0	0
1718	OAK	0	0	0	0	0	13	0	0	0	0	0	0
1719	ELM	0	0	0	0	0	10	0	0	0	0	0	0
1720	OAK	0	0	0	0	0	13	0	0	0	0	0	0
1721	OAK	0	0	0	0	0	9	0	0	0	0	0	0
1722	OAK	0	0	0	0	0	11	0	0	0	0	0	0
1723	OAK	0	0	0	0	0	9	0	0	0	0	0	0
1724	OAK	0	0	0	0	0	9	0	0	0	0	0	0
1725	OAK	0	0	0	0	0	9	0	0	0	0	0	0
1726	OAK	0	0	0	0	0	12	0	0	0	0	0	0
1727	OAK	0	0	0	0	0	9	0	0	0	0	0	0
1728	OAK	0	0	0	0	0	10	0	0	0	0	0	0
1729	OAK	0	0	0	0	0	12	0	0	0	0	0	0
1730	OAK	0	0	0	0	0	9	0	0	0	0	0	0
1731	MESQUITE	0	0	0	0	0	10	0	0	0	0	0	0
1733	CEDAR	0	0	0	0	0	20	0	0	0	0	0	0
1734	OAK	0	0	0	0	0	13	0	0	0	0	0	0
1735	CEDAR	0	0	0	0	0	19	0	0	0	0	0	0
1736	CEDAR	0	0	0	0	0	11	0	0	0	0	0	0
1737	CEDAR	0	0	0	0	8	0	0	0	0	0	0	0
1738	OAK	9	0	0	0	0	0	0	0	0	0	0	0
1739	OAK	0	0	0	0	7	0	0	0	0	0	0	0
1740	CEDAR	0	0	0	0	0	12	0	0	0	0	0	0
1741	OAK	9	0	0	0	0	0	0	0	0	0	0	0
1742	OAK	10	0	0	0	0	0	0	0	0	0	0	0
1743	OAK	10	0	0	0	0	0	0	0	0	0	0	0
1744	CEDAR	12	0	0	0	0	0	0	0	0	0	0	0
1745	CEDAR	10	0	0	0	0	0	0	0	0	0	0	0
1746	OAK	9	0	0	0	0	0	0	0	0	0	0	0
1747	ELM	9	0	0	0	0	0	0	0	0	0	0	0
1748	OAK	7	0	0	0	0	0	0	0	0	0	0	0
1749	ELM	9	0	0	0	0	0	0	0	0	0	0	0
1750	OAK	6	0	0	0	0	0	0	0	0	0	0	0
1751	OAK	7	0	0	0	0	0	0	0	0	0	0	0
1752	ELM	12	0	0	0	0	0	0	0	0	0	0	0
1753	OAK	11	0	0	0	0	0	0	0	0	0	0	0
1754	OAK	9	0	0	0	0	0	0	0	0	0	0	0
1755	OAK	9	0	0	0	0	0	0	0	0	0	0	0
1756	ELM	9	0	0	0	0	0	0	0	0	0	0	0
1757	OAK	7	0	0	0	0	0	0	0	0	0	0	0
1758	OAK	6	0	0	0	0	0	0	0	0	0	0	0
1759	OAK	8	0	0	0	0	0	0	0	0	0	0	0
1760	OAK	10	0	0	0	0	0	0	0	0	0	0	0
1761	OAK	0	0	0	0	0	6	0	0	0	0	0	0
1762	OAK	10	0	0	0	0	0	0	0	0	0	0	0
1763	OAK	0	0	0	0	10	0	0	0	0	0	0	0
1764	OAK	0	0	0	0	8	0	0	0	0	0	0	0
1765	OAK	11	0	0	0	0	0	0	0	0	0	0	0
1766	ELM	8	0	0	0	0	0	0	0	0	0	0	0
1767	OAK	6	0	0	0	0	0	0	0	0	0	0	0

LARGE SIGNIFICANT TREE PRESERVATION LIST												
POINT #	SPECIES	EXEMPT (ROW)	FLOODPLAIN		ENV SENS AREA		EASEMENT		NON EXEMPT		SHADE VALUE	
		REMOVE	REMOVE	PRESERVE	REMOVE	PRESERVE	REMOVE	PRESERVE	REMOVE	PRESERVE		
1768	OAK	0	0	0	0	0	0	8	0	0	0	0
1769	OAK	0	0	0	0	0	0	11	0	0	0	0
1770	OAK	0	0	0	0	0	0	7	0	0	0	0
1771	OAK	0	0	0	0	0	0	8	0	0	0	0
1772	OAK	0	0	0	0	0	0	8	0	0	0	0
1773	OAK	0	0	0	0	0	0	0	0	7	0	0
1774	OAK	9	0	0	0	0	0	0	0	0	0	0
1775	ELM	10	0	0	0	0	0	0	0	0	0	0
1777	OAK	0	0	0	0	0	0	0	0	14	0	0
1778	CEDAR	0	0	0	0	0	0	0	0	11	0	0
1779	CEDAR	0	0	0	0	0	0	0	0	10	0	0
1780	OAK	0	0	0	0	0	0	0	0	13	0	0
1781	CEDAR	0	0	0	0	0	0	0	0	10	0	0
1782	OAK	0	0	0	0	0	0	0	0	9	0	0
1785	OAK	0	0	0	0	0	0	0	0	15	0	0
1786	OAK	0	0	0	0	0	0	0	0	18	0	0
1787	OAK	0	0	0	0	0	0	0	0	13	0	0
1788	OAK	0	0	0	0	0	0	0	0	11	0	0
1789	OAK	0	0	0	0	0	0	0	0	6	0	0
1808	CEDAR	0	0	0	0	0	0	0	0	17	0	0
1809	CEDAR	0	0	0	0	0	0	0	0	12	0	0
1810	CEDAR	0	0	0	0	0	0	13	0	0	0	0
1811	CEDAR	0	0	0	0	0	0	0	0	12	0	0
1812	HACKBERRY	0	0	0	0	0	0	0	0	10	0	0
1813	CEDAR	0	0	0	0	0	0	0	0	12	0	0
1814	CEDAR	0	0	0	0	0	0	0	0	14	0	0
1815	CEDAR	0	0	0	0	0	0	0	0	13	0	0
1816	CEDAR	0	0	0	0	0	0	0	0	21	0	0
1817	CEDAR	0	0	0	0	0	0	0	0	20	0	0
1818	CEDAR	0	0	0	0	0	0	0	0	16	0	0
1819	CEDAR	0	0	0	0	0	0	0	0	10	0	0
1820	MESQUITE	0	0	0	0	0	0	0	0	20	0	0
1821	CEDAR	0	0	0	0	0	0	0	0	10	0	0
1822	HACKBERRY	0	0	0	0	0	0	0	0	17	0	0
1823	OAK	0	0	0	0	0	0	0	0	11	0	0
1824	OAK	0	0	0	0	0	0	0	0	19	0	0
1825	OAK	0	0	0	0	0	0	9	0	0	0	0
1826	OAK	0	0	0	0	0	0	7	0	0	0	0
1827	OAK	0	0	0	0	0	0	0	0	7	0	0
1828	OAK	20	0	0	0	0	0	0	0	0	0	0
1829	OAK	8	0	0	0	0	0	0	0	0	0	0
1830	OAK	7	0	0	0	0	0	0	0	0	0	0
1831	OAK	9	0	0	0	0	0	0	0	0	0	0
1832	OAK	12	0	0	0	0	0	0	0	0	0	0
1833	OAK	8	0	0	0	0	0	0	0	0	0	0
1834	OAK	8	0	0	0	0	0	0	0	0	0	0
1835	OAK	8	0	0	0	0	0	0	0	0	0	0
1836	OAK	7	0	0	0	0	0	0	0	0	0	0
1837	OAK	9	0	0	0	0	0	0	0	0	0	0
1838	OAK	8	0	0	0	0	0	0	0	0	0	0
1839	OAK	0	0	0	0	0	0	8	0	0	0	0
1840	OAK	6	0	0	0	0	0	0	0	0	0	0
1841	CEDAR	0	0	0	0	0	0	10	0	0	0	0
1842	OAK	0	0	0	0	0	0	7	0	0	0	0
1843	OAK	0	0	0	0	0	0	8	0	0	0	0
1844	HACKBERRY	0	0	0	0	0	0	10	0	0	0	0
1845	OAK	0	0	0	0	0	0	8	0	0	0	0
1846	OAK	0	0	0	0	0	0	0	0	9	0	0
1847	OAK	0	0	0	0	0	0	0	0	8	0	0
1848	OAK	0	0	0	0	0	0	0	0	8	0	0
1849	OAK	0	0	0	0	0	0	0	0	6	0	0
1850	OAK	0	0	0	0	0	0	0	0	9	0	0
1851	OAK	0	0	0	0	0	0	0	0	7	0	0
1852	OAK	0	0	0	0	0	0	0	0	8	0	0
1853	OAK	0	0	0	0	0	0	0	0	6	0	0
1854	OAK	0	0	0	0	0	0	0	0	6	0	0
1855	OAK	0	0	0	0	0	0	0	0	6	0	0
1856	OAK	0	0	0	0	0	0	0	0	7	0	0
1857	OAK	0	0	0	0	0	0	0	0	8	0	0
1858	OAK	0	0	0	0	0	0	0	0	6	0	0
1859	OAK	0	0	0	0	0	0	0	0	6	0	0
1860	OAK	0	0	0	0	0	0	0	0	6	0	0
1861	OAK	0	0	0	0	0	0	0	0	7	0	0
1862	OAK	0	0	0	0	0	0	0	0	8	0	0
1863	OAK	0	0	0	0	0	0	7	0	0	0	0
1864	OAK	0	0	0	0	0	0	0	0	6	0	0
1865	OAK	0	0	0	0	0	0	12	0	0	0	0
1866	OAK	8	0	0	0	0	0	0	0	0	0	0
1866	OAK	8	0	0	0	0	0	0	0	0	0	0
1867	OAK	0	0	0	0	0	0	7	0	0	0	0
1868	OAK	0	0	0	0	0	0	6	0	0	0	0
1869	OAK	0	0	0	0	0	0	6	0	0	0	0
1870	OAK	0	0	0	0	0	0	0	0	6	0	0
1871	OAK	0	0	0	0	0	0	0	0	6	0	0
1872	OAK	0	0	0	0	0	0	0	0	9	0	0
1873	OAK	0	0	0	0	0	0	0	0	6	0	0
1874	OAK	0	0	0	0	0	0	0	0	7	0	0
1875	OAK	0	0	0	0	0	0	0	0	8	0	0
1876	OAK	0	0	0	0	0	0	0	0	8	0	0
1877	OAK	0	0	0	0	0	0	0	0	12	0	0
1878	OAK	0	0	0	0	0	0	0	0	9	0	0
1879	OAK	0	0	0	0	0	0	0	0	7	0	0
1880	OAK	0	0	0	0	0	0	0	0	9	0	0
1881	OAK	0	0	0	0	0	0	0	0	7	0	0
1883	OAK	0	0	0	0	0	0	0	0	14	0	0
1884	OAK	0	0	0	0	0	0	0	0	21	0	0
1885	OAK	0	0	0	0	0	0	0	0	6	0	0
1886	OAK	0	0	0	0	0	0	0	0	9	0	0
1887	OAK	0	0	0	0	0	0	0	0	10	0	0
1888	CEDAR	0	0	0	0	0	0	0	0	17	0	0
1889	OAK	0	0	0	0	0	0	0	0	19	0	0
1901	CEDAR	11	0	0	0	0	0	0	0	0	0	0
1902	CEDAR	0	0	0	0	0	0	0	0	13	0	0
1903	CEDAR	10	0	0	0	0	0	0	0	0	0	0
1904	CEDAR	0	0	0	0	0	0	0	0	19	0	0



LARGE SIGNIFICANT TREE PRESERVATION LIST											
POINT #	SPECIES	EXEMPT (ROW)	FLOODPLAIN		ENV SENS AREA		EASEMENT		NON EXEMPT		SHADE VALUE
		REMOVE	REMOVE	PRESERVE	REMOVE	PRESERVE	REMOVE	PRESERVE	REMOVE	PRESERVE	
2177	OAK	0	0	0	0	0	13	0	0	0	0
2178	CEDAR	0	0	0	0	0	21	0	0	0	0
2186	OAK	0	0	0	0	0	14	0	0	0	0
2187	OAK	0	0	0	0	0	9	0	0	0	0
2188	ELM	0	0	0	0	0	9	0	0	0	0
2189	OAK	0	0	0	0	0	6	0	0	0	0
2190	OAK	0	0	0	0	0	8	0	0	0	0
2196	CEDAR	0	0	0	0	0	18	0	0	0	0
2197	OAK	0	0	0	0	0	14	0	0	0	0
2198	OAK	0	0	0	0	0	14	0	0	0	0
2199	CEDAR	0	0	0	0	0	12	0	0	0	0
2204	CEDAR	0	0	0	0	0	0	0	13	0	0
2206	CEDAR	0	0	0	0	0	0	0	23	0	0
2207	CEDAR	0	0	0	0	0	0	0	12	0	0
2208	CEDAR	0	0	0	0	0	0	0	17	0	0
2209	CEDAR	0	0	0	0	0	0	0	14	0	0
2218	HACKBERRY	0	0	0	0	0	0	0	10	0	0
2219	CEDAR	0	0	0	0	0	0	0	10	0	0
2220	MESQUITE	0	0	0	0	0	0	0	12	0	0
2222	CEDAR	0	0	0	0	0	0	0	12	0	0
2223	CEDAR	0	0	0	0	0	0	0	19	0	0
2224	HACKBERRY	0	0	0	0	0	0	0	10	0	0
2235	CEDAR	0	0	0	0	0	0	0	0	23	379
2236	MESQUITE	0	0	0	0	0	0	0	10	0	0
2237	CEDAR	0	0	0	0	0	0	0	15	0	0
2239	MESQUITE	0	0	0	0	0	0	0	13	0	0
2240	CEDAR	0	0	0	0	0	0	0	11	0	0
2242	MESQUITE	0	0	0	0	0	0	0	10	0	0
2244	CEDAR	0	0	0	0	0	0	0	15	0	0
2245	CEDAR	0	0	0	0	0	0	0	10	0	0
2246	CEDAR	0	0	0	0	0	0	0	0	15	247
2284	CEDAR	0	0	0	0	0	0	0	16	0	0
2286	OAK	0	0	0	0	0	0	0	8	0	0
2293	OAK	0	0	0	0	0	0	0	7	0	0
2294	OAK	0	0	0	0	0	0	0	10	0	0
2295	OAK	0	0	0	0	0	0	0	7	0	0
2296	OAK	0	0	0	0	0	0	0	6	0	0
2310	CEDAR	0	0	0	0	0	0	0	18	0	0
2311	CEDAR	0	0	0	0	0	0	0	21	0	0
2312	CEDAR	0	0	0	0	0	0	0	12	0	0
2313	CEDAR	0	0	0	0	0	0	0	13	0	0
2314	CEDAR	18	0	0	0	0	0	0	0	0	0
2316	CEDAR	19	0	0	0	0	0	0	0	0	0
2317	CEDAR	0	0	0	0	0	0	0	22	0	0
2318	CEDAR	0	0	0	0	0	0	0	10	0	0
2319	CEDAR	0	0	0	0	0	0	0	16	0	0
2320	CEDAR	0	0	0	0	0	0	0	12	0	0
2321	CEDAR	0	0	0	0	0	0	0	16	0	0
2322	CEDAR	0	0	0	0	0	0	0	15	0	0
2323	CEDAR	0	0	0	0	0	0	0	17	0	0
2324	CEDAR	0	0	0	0	0	0	0	15	0	0
2325	CEDAR	0	0	0	0	0	0	0	10	0	0
2326	CEDAR	0	0	0	0	0	0	0	15	0	0
2327	CEDAR	0	0	0	0	0	0	0	19	0	0
2328	CEDAR	0	0	0	0	0	0	0	17	0	0
2329	CEDAR	12	0	0	0	0	0	0	0	0	0
2330	CEDAR	17	0	0	0	0	0	0	0	0	0
2331	CEDAR	0	0	0	0	0	0	0	20	0	0
2332	HACKBERRY	0	0	0	0	0	0	0	11	0	0
2333	MESQUITE	0	0	0	0	0	0	0	14	0	0
2334	CEDAR	0	0	0	0	0	0	0	10	0	0
2335	CEDAR	0	0	0	0	0	0	0	11	0	0
2336	CEDAR	0	0	0	0	0	0	0	19	0	0
2337	CEDAR	0	0	0	0	0	0	0	11	0	0
2338	CEDAR	0	0	0	0	0	0	0	10	0	0
2339	CEDAR	0	0	0	0	0	0	0	0	16	263
2340	CEDAR	0	0	0	0	0	0	0	0	14	231
2341	CEDAR	0	0	0	0	0	0	0	13	0	0
2342	CEDAR	0	0	0	0	0	0	0	14	0	0
2343	CEDAR	0	0	0	0	0	0	0	11	0	0
2344	CEDAR	0	0	0	0	0	0	0	12	0	0
2345	CEDAR	0	0	0	0	0	0	0	11	0	0
2346	CEDAR	0	0	0	0	0	10	0	0	0	0
2347	CEDAR	0	0	0	0	0	0	0	10	0	0
2348	CEDAR	0	0	0	0	0	0	0	12	0	0
2349	CEDAR	17	0	0	0	0	0	0	0	0	0
2350	CEDAR	11	0	0	0	0	0	0	0	0	0
2351	CEDAR	19	0	0	0	0	0	0	0	0	0
2352	CEDAR	0	0	0	0	0	0	0	11	0	0
2353	MESQUITE	0	0	0	0	0	0	0	13	0	0
2354	OAK	0	0	0	0	0	0	0	10	0	0
2355	OAK	0	0	0	0	0	0	0	9	0	0
2356	OAK	0	0	0	0	0	0	0	8	0	0
2357	OAK	0	0	0	0	0	0	0	16	0	0
2358	OAK	0	0	0	0	0	0	0	9	0	0
2359	OAK	0	0	0	0	0	0	0	0	12	629
2360	OAK	0	0	0	0	0	0	8	0	0	419
2361	OAK	0	0	0	0	0	15	0	0	0	0
2362	OAK	0	0	0	0	0	9	0	0	0	0
2363	OAK	0	0	0	0	0	7	0	0	0	0
2364	OAK	9	0	0	0	0	0	0	0	0	0
2365	OAK	12	0	0	0	0	0	0	0	0	0
2366	OAK	18	0	0	0	0	0	0	0	0	0
2367	OAK	12	0	0	0	0	0	0	0	0	0
2368	OAK	0	0	0	0	0	13	0	0	0	0
2369	OAK	0	0	0	0	0	0	0	16	0	0
2370	OAK	0	0	0	0	0	0	0	15	0	0
2371	OAK	0	0	0	0	0	0	0	15	0	0
2372	OAK	0	0	0	0	0	0	0	18	0	0
2373	OAK	0	0	0	0	0	0	0	19	0	0
2374	ELM	0	0	0	0	0	0	0	9	0	0
2375	OAK	0	0	0	0	0	0	0	13	0	0
2376	ELM	0	0	0	0	0	0	0	10	0	0
2377	CEDAR	15	0	0	0	0	0	0	0	0	0
2378	CEDAR	20	0	0	0	0	0	0	0	0	0



P:\021421\631\2-Drawings\Exhibits\Tree Preservation\2021-10-06 - McCrany Unit 3 Tree Plan [Take 1 & OHE].dwg, 2021/10/13 6:01pm mtrinkle

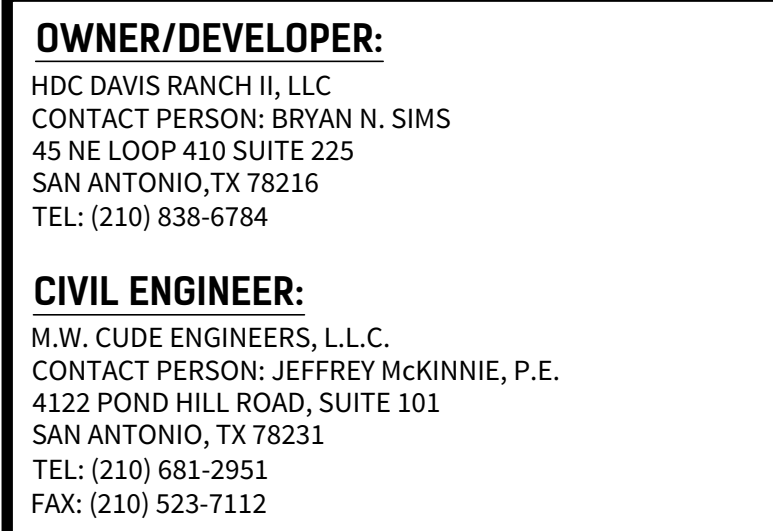

2

2

4122 Pond Hill Road, Suite 101
San Antonio, Texas 78231
P:(210) 681.2951 F: (210) 523.7112

McCrary Tract

UNIT 3

TREE PRESERVATION PLAN

DATE _____

10/13/2021

PROJECT NO.
02142.631

DRAWN BY
JRT/MAT/NNR

CHECKED BY
JAM/SWM

REVISIONS

1 01/28/2021 - TREE REVISIONS

07/20/2021 - ADD E.G.T.CA. EA

2. BETWEEN LOTS 43 & 44

3. _____

4.

5.

.....

b.

7. _____

8.

9

10. *Journal of the American Medical Association*, 2000; 283: 2686-2692.

CUDE ENGINEERS

TBPE No. 455
TBPLS No. 10048500

LAND-PLAT
20-11800554

SAWS JOB NO

TPP-10

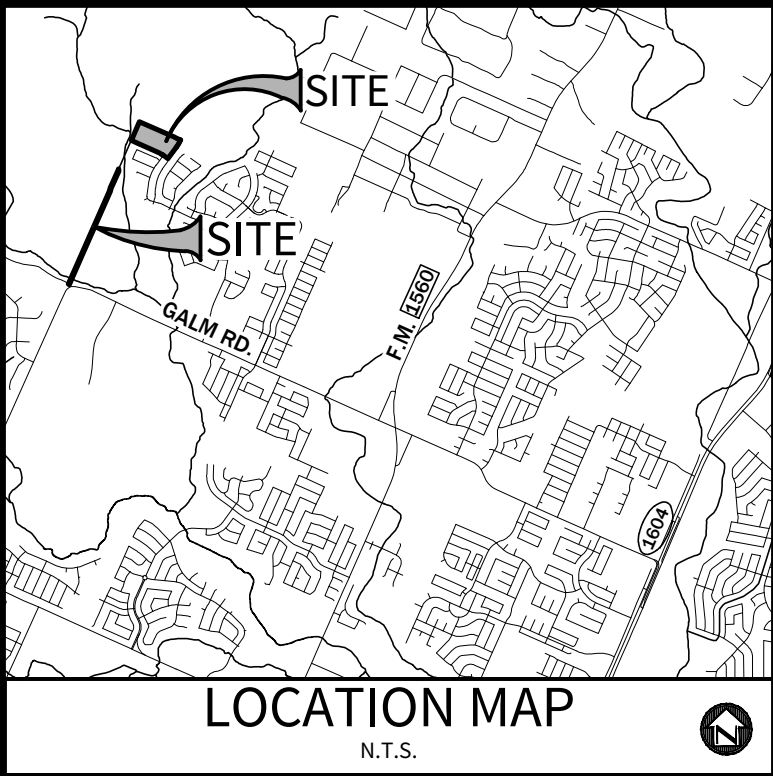

OWNER/DEVELOPER:
HDC DAVIS RANCH II, LLC
CONTACT PERSON: BRYAN N. SIMS
45 NE LOOP 410 SUITE 225
SAN ANTONIO, TX 78216
TEL: (210) 838-6784

CIVIL ENGINEER:
M.W. CUDE ENGINEERS, L.L.C.
CONTACT PERSON: JEFFREY MCKINNIE, P.E.
4122 POND HILL ROAD, SUITE 101
SAN ANTONIO, TX 78231
TEL: (210) 681-2951
FAX: (210) 523-7112

TREE PRESERVATION LIST					
Point No.	Species	Inches	Preserve	FP/ESA/NFP	Tree Type
654	CEDAR.ELM	8	NO	FP	SIGNIFICANT
655	CEDAR.ELM	9	NO	FP	SIGNIFICANT
663	CEDAR.ELM	9	NO	FP	SIGNIFICANT
664	CEDAR.ELM	10	NO	FP	SIGNIFICANT
665	CEDAR.ELM	15	NO	FP	SIGNIFICANT
738	HACKBERRY	11	NO	FP	SIGNIFICANT
746	CEDAR	14	NO	FP	SIGNIFICANT
748	CEDAR	13	NO	FP	SIGNIFICANT
753	MESQUITE	13	NO	FP	SIGNIFICANT
754	CEDAR	13	NO	FP	SIGNIFICANT
755	CEDAR	15	NO	FP	SIGNIFICANT
40005	OAK	11	NO	NFP	SIGNIFICANT
40006	CEDAR	12	NO	NFP	SIGNIFICANT
40007	CEDAR	13	NO	NFP	SIGNIFICANT
40008	OAK	6	NO	ESA	SIGNIFICANT
40009	OAK	6	NO	ESA	SIGNIFICANT
40010	CEDAR	11	NO	FP	SIGNIFICANT
40011	ELM	12	NO	ESA	SIGNIFICANT
40019	CEDAR	15	NO	NFP	SIGNIFICANT
40020	OAK	10	NO	NFP	SIGNIFICANT
40025	ELM	10	NO	NFP	SIGNIFICANT
40026	CEDAR	11	NO	NFP	SIGNIFICANT
40027	CEDAR	13	NO	NFP	SIGNIFICANT
40028	CEDAR	11	NO	NFP	SIGNIFICANT
40029	CEDAR	13	NO	NFP	SIGNIFICANT
40030	CEDAR	10	NO	NFP	SIGNIFICANT
40031	OAK	9	NO	NFP	SIGNIFICANT
40050	CEDAR	10	NO	NFP	SIGNIFICANT
40051	OAK	6	NO	NFP	SIGNIFICANT
40052	OAK	9	NO	NFP	SIGNIFICANT
40062	OAK	6.5	NO	NFP	SIGNIFICANT
40063	OAK	9	NO	NFP	SIGNIFICANT
40064	OAK	6	NO	NFP	SIGNIFICANT
40073	OAK	8.5	NO	NFP	SIGNIFICANT
40074	CEDAR	11	NO	NFP	SIGNIFICANT
40075	OAK	8	NO	NFP	SIGNIFICANT
40076	CEDAR	12	NO	NFP	SIGNIFICANT
40077	CEDAR	11.5	NO	NFP	SIGNIFICANT
40086	ELM	8.5	NO	NFP	SIGNIFICANT
40087	CEDAR	15.5	NO	NFP	SIGNIFICANT
40088	CEDAR	10	NO	NFP	SIGNIFICANT
40089	OAK	8	NO	NFP	SIGNIFICANT
40090	ELM	9	NO	NFP	SIGNIFICANT
40091	CEDAR	14	NO	NFP	SIGNIFICANT
40099	OAK	9.5	NO	NFP	SIGNIFICANT
40100	OAK	8	NO	NFP	SIGNIFICANT
40101	OAK	7.5	NO	NFP	SIGNIFICANT
40116	OAK	6.5	NO	NFP	SIGNIFICANT
40117	OAK	13	NO	NFP	SIGNIFICANT
40118	OAK	11.5	NO	NFP	SIGNIFICANT
40119	OAK	11.5	NO	NFP	SIGNIFICANT
40120	OAK	6.5	NO	NFP	SIGNIFICANT
40121	ELM	7.5	NO	NFP	SIGNIFICANT
40122	CEDAR	10.5	NO	NFP	SIGNIFICANT
40123	ELM	13.5	NO	NFP	SIGNIFICANT
40124	ELM	9	NO	NFP	SIGNIFICANT
40125	CEDAR	11	NO	NFP	SIGNIFICANT
40126	OAK	7	NO	NFP	SIGNIFICANT
40127	OAK	8	NO	NFP	SIGNIFICANT
40128	CEDAR	12	NO	NFP	SIGNIFICANT
40129	OAK	10	NO	NFP	SIGNIFICANT
40130	CEDAR	11	NO	NFP	SIGNIFICANT
40144	CEDAR	16	NO	NFP	SIGNIFICANT
40145	OAK	13	NO	NFP	SIGNIFICANT
40148	OAK	10	NO	NFP	SIGNIFICANT
40149	ELM	10	NO	NFP	SIGNIFICANT
40150	CEDAR	10	NO	NFP	SIGNIFICANT
40152	OAK	15	NO	NFP	SIGNIFICANT
40153	OAK	12	NO	NFP	SIGNIFICANT
40157	OAK	15	NO	NFP	SIGNIFICANT
40167	CEDAR	16	NO	NFP	SIGNIFICANT
40168	CEDAR	11	NO	NFP	SIGNIFICANT
40172	CEDAR	11	NO	NFP	SIGNIFICANT
40184	OAK	9	NO	NFP	SIGNIFICANT
40185	OAK	7	NO	NFP	SIGNIFICANT
40186	OAK	12	NO	NFP	SIGNIFICANT
40187	ELM	10	NO	NFP	SIGNIFICANT
40188	HACKBERRY	11	NO	NFP	SIGNIFICANT
40196	CEDAR	16	NO	NFP	SIGNIFICANT

TREE PRESERVATION LIST					
Point No.	Species	Inches	Preserve	FP/ESA/NFP	Tree Type
40197	CEDAR	12	NO	NFP	SIGNIFICANT
40199	ELM	11.5	NO	NFP	SIGNIFICANT
40200	MESQUITE	10	NO	NFP	SIGNIFICANT
40201	OAK	16	NO	NFP	SIGNIFICANT
40202	MESQUITE	12	NO	NFP	SIGNIFICANT
40203	CEDAR	10	NO	NFP	SIGNIFICANT
40204	ELM	6.5	NO	NFP	SIGNIFICANT
40205	MESQUITE	20.5	NO	NFP	SIGNIFICANT
40206	MESQUITE	12	NO	NFP	SIGNIFICANT
40207	ELM	18	NO	NFP	SIGNIFICANT
40208	MESQUITE	16	NO	NFP	SIGNIFICANT
40209	OAK	6	NO	NFP	SIGNIFICANT
40210	ELM	6	NO	NFP	SIGNIFICANT
40211	ELM	13	NO	NFP	SIGNIFICANT
40212	OAK	17	NO	NFP	SIGNIFICANT
40213	OAK	20	NO	NFP	SIGNIFICANT
40214	OAK	15	NO	NFP	SIGNIFICANT
40215	OAK	12	NO	NFP	SIGNIFICANT
40216	OAK	28	NO	NFP	HERITAGE
40217	OAK	6	NO	NFP	SIGNIFICANT
40218	OAK	10	NO	NFP	SIGNIFICANT
40503	OAK	12.5	NO	NFP	SIGNIFICANT
40504	OAK	13.5	NO	NFP	SIGNIFICANT
40505	CEDAR	10.5	NO	NFP	SIGNIFICANT
40506	OAK	13	NO	NFP	SIGNIFICANT
40507	OAK	13	NO	NFP	SIGNIFICANT
40508	OAK	12.5	NO	NFP	SIGNIFICANT
40509	CEDAR	11.5	NO	NFP	SIGNIFICANT
40510	OAK	22	NO	NFP	SIGNIFICANT
40511	OAK	24	NO	NFP	HERITAGE
40515	CEDAR	18	NO	NFP	SIGNIFICANT
40516	OAK	8.5	NO	NFP	SIGNIFICANT
40518	OAK	21.5	NO	NFP	SIGNIFICANT
40519	OAK	12.5	NO	NFP	SIGNIFICANT
40520	OAK	12.5	NO	NFP	SIGNIFICANT
40521	OAK	6	NO	NFP	SIGNIFICANT
40522	OAK	12.5	NO	NFP	SIGNIFICANT
40523	OAK	21.5	NO	NFP	SIGNIFICANT
40524	OAK	6.5	NO	NFP	SIGNIFICANT
40525	CEDAR	12	NO	NFP	SIGNIFICANT
40526	CEDAR	11.5	NO	NFP	SIGNIFICANT
40527	OAK	9.5	NO	NFP	SIGNIFICANT
40528	OAK	23.5	NO	NFP	SIGNIFICANT
40529	CEDAR	10	NO	NFP	SIGNIFICANT
40530	OAK	10	NO	NFP	SIGNIFICANT
40531	OAK	7.5	NO	NFP	SIGNIFICANT
40532	CEDAR	14	NO	NFP	SIGNIFICANT
40534	CEDAR	10.5	NO	NFP	SIGNIFICANT
40535	OAK	12	NO	NFP	SIGNIFICANT
40536	OAK	8	NO	NFP	SIGNIFICANT
40537	OAK	9.5	NO	NFP	SIGNIFICANT
40538	OAK	7	NO	NFP	SIGNIFICANT
40539	OAK	7.5	NO	NFP	SIGNIFICANT
40540	OAK	9.5	NO	NFP	SIGNIFICANT
40542	OAK	6	NO	NFP	SIGNIFICANT
40543	OAK	17	NO	NFP	SIGNIFICANT
40544	OAK	7.5	NO	NFP	SIGNIFICANT
40545	OAK	7	NO	NFP	SIGNIFICANT
40546	OAK	6.5	NO	NFP	SIGNIFICANT
40547	OAK	9.5	NO	NFP	SIGNIFICANT
40548	OAK	8.5	NO	NFP	SIGNIFICANT
40549	OAK	11	NO	NFP	SIGNIFICANT
40550	OAK	10.5	NO	NFP	SIGNIFICANT
40551	OAK	9.5	NO	NFP	SIGNIFICANT
40552	OAK	9	NO	NFP	SIGNIFICANT
40553	OAK	13	NO	NFP	SIGNIFICANT
40557	OAK	19.5	NO	NFP	SIGNIFICANT
40559	HACKBERRY	11.5	NO	NFP	SIGNIFICANT
40561	OAK	12	NO	NFP	SIGNIFICANT
40562	OAK	14	NO	NFP	SIGNIFICANT
40563	OAK	19	NO	NFP	SIGNIFICANT
40571	OAK	13.5	NO	NFP	SIGNIFICANT
40572	OAK	13.5	NO	NFP	SIGNIFICANT
40576	OAK	11	NO	NFP	SIGNIFICANT
40577	OAK	8	NO	NFP	SIGNIFICANT
40578	OAK	10.5	NO	NFP	SIGNIFICANT
40579	OAK	25.5	NO	NFP	HERITAGE
40580	HACKBERRY	12	NO	NFP	SIGNIFICANT
40581	OAK (IN DECLINE)	33.5	NO		
40589	OAK	20	NO	FP	SIGNIFICANT
40590	OAK	20	NO	FP	SIGNIFICANT
40595	OAK	24	NO	NFP	HERITAGE

*TREE 40581 IS NOT INCLUDED IN THE CALCULATIONS BECAUSE IT IS IN DECLINE.

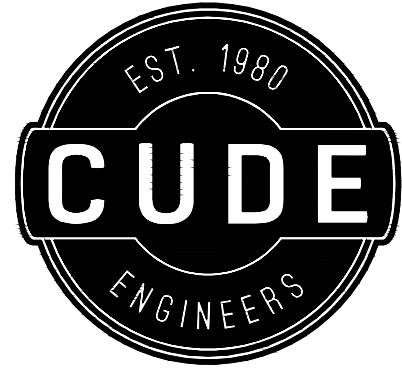

4122 Pond Hill Road, Suite 101
San Antonio, Texas 78231
P:(210) 681.2951 F: (210) 523.7112

MCCRARY TRACT
UNIT 3
TREE PRESERVATION PLAN

DATE
10/13/2021
PROJECT NO.
02142.631
DRAWN BY
JRT/MAT/NNR
CHECKED BY
JAM/SWM

- REVISIONS
- 10/06/2021 - COMBINED CPS OHE
 - 10/13/2021 - REVISE TREE #40216 AND ADD TREE #40595
 -
 -
 -
 -
 -
 -
 -

CUDE ENGINEERS
TBPE No. 455
TBPLS No. 10048500

LAND - PLAT
20-11800554
SAWS JOB NO.

TPP-11